



Metamorphosis loomma



Metamorphosis | bomma



Metamorphosis Inspiration

The transformation of crystal into a stunning lighted jewel

BOMMA Glassworks and Rückl jointly introduce Metamorphosis, a collection of crystal lighting by Rony Plesl. This collection combines the talents of these sister glassmaking brands – the breathtaking art of hand-cut crystal from Rückl, with exceptional technical solutions and the principle of light constellations typical for BOMMA. Metamorphosis is a transformation from one form into another. Metamorphosis as the transformation of crystal into a stunning lighted jewel in any interior, creates a variable jewel that enables your own compositions.

Design by Rony Plesl



Metamorphosis Production







Metamorphosis Projects







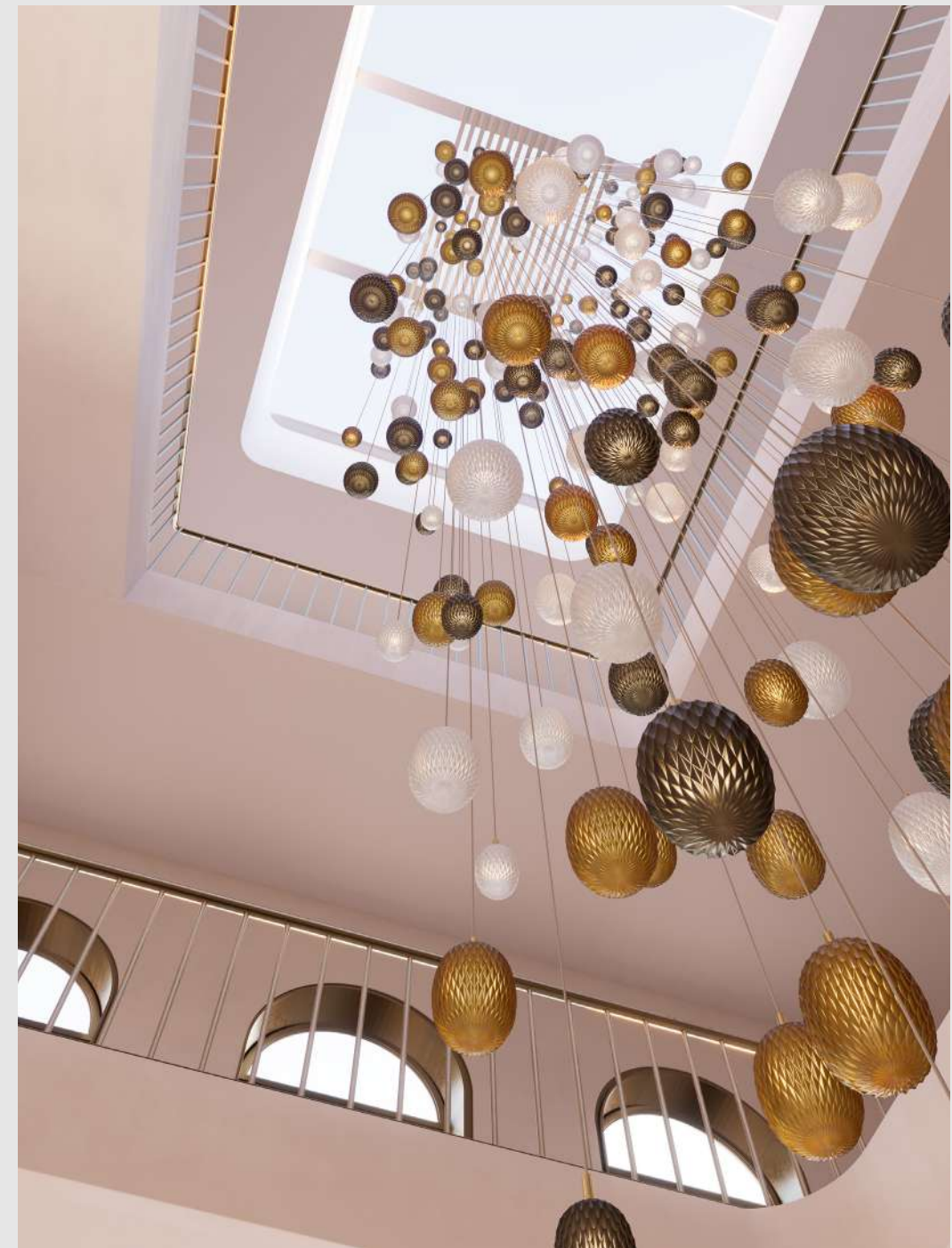

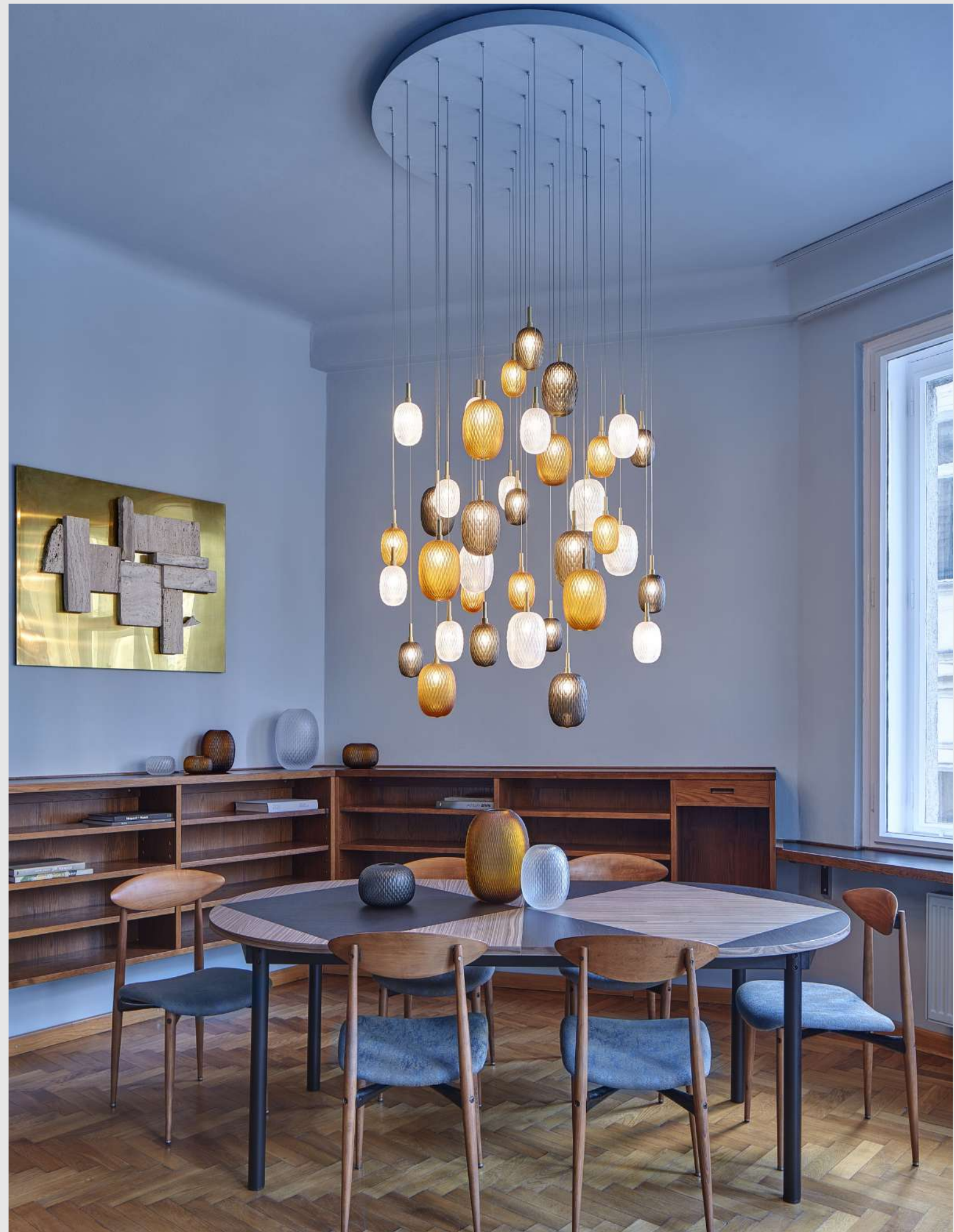



Metamorphosis Options

Options

Pendant
Small

Glass options

clear

cigar

amber

Fitting options

brushed gold

anthracite



Options

Pendant
Large

Glass options

clear

cigar

amber

Fitting options

brushed gold

anthracite



Clear / Brushed gold



Cigar / Anthracite



Amber / Brushed gold

Options

Wall
Small

Glass options

clear

cigar

amber

Fitting options

brushed gold

brushed silver



Options

Wall
Large

Glass options

clear

cigar

amber

Fitting options

brushed gold

brushed silver



Metamorphosis

Technical Information

METAMORPHOSIS

small pendant

Design by
Rony Plesl

Handmade glass attributes

All Bomma products are hand-made from mouth-blown lead-free crystal. Therefore any small bubbles and irregularities in the glass are both a proof and a characteristic feature of this traditional craft.

The Metamorphosis Collection is produced in three colors, simply referred to as amber, smoke and clear. The clear version is made from pure crystal glass, while cigar and amber are produced from solid-color crystal. Each piece is original, thanks to the hand-cutting process. The clear and amber versions are cut using a diamond pattern, cigar is decorated with a curved geometric design. Being hand-made, the individual products can slightly differ in tone, color intensity or cut.

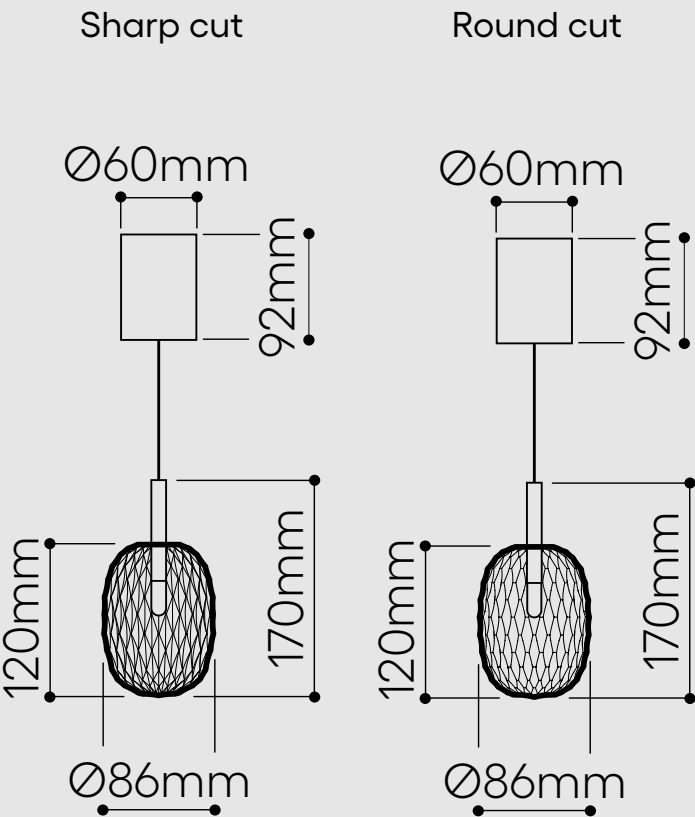

Metamorphosis bomma

LIGHTING DESCRIPTION

Size	dia 86 × H 170 dia 3,4 × H 6,7 inch
Cable	transparent 2,5 m / 98,4 inch
Weight	+ - 0,45 kg / 1 lb
Glass	mouth-blown lead-free crystal in clear, cigar, amber
Mounting	brushed gold (brushed brass) anthracite (brass and galvanized black nickel)
Protection	IP 20
Nominal voltage	220-240V / A.C. 50 hz (EU) 110-120 V / A.C. 60 Hz (USA)
Class	III. EU / II. USA

LIGHT SOURCE

Type	G4, 1,2W LED, 100 lm
Base	G4 (EU) / G4 (USA)
Voltage	12V, AC
Temperature	2700 K
Color index	RA 90+
Dimming	EU/Other versions - dimmable in constellations, non dimmable as a single pendant. UL/The Americas - dimmable in constellations and as a single pendant.

TRANSFORMER

Primary	100-240V, 50/60 Hz, 0,04A
Secondary	DC 700mA (0,5V-4V) 1x3W

PACKAGING

Material	Cardboard
Size	185 × 165 × 165 mm 7,3 × 6,5 × 6,5 inch

Origin: traditionally produced in the Czech Republic
Intellectual property license holder: Bomma Czech Republic (EU)
Represented by BMRC group s.r.o.

CERTIFICATES



METAMORPHOSIS

large pendant

Design by
Rony Plesl

Handmade glass attributes

All Bomma products are hand-made from mouth-blown lead-free crystal. Therefore any small bubbles and irregularities in the glass are both a proof and a characteristic feature of this traditional craft.

The Metamorphosis Collection is produced in three colors, simply referred to as amber, smoke and clear. The clear version is made from pure crystal glass, while cigar and amber are produced from solid-color crystal. Each piece is original, thanks to the hand-cutting process. The clear and amber versions are cut using a diamond pattern, cigar is decorated with a curved geometric design. Being hand-made, the individual products can slightly differ in tone, color intensity or cut.

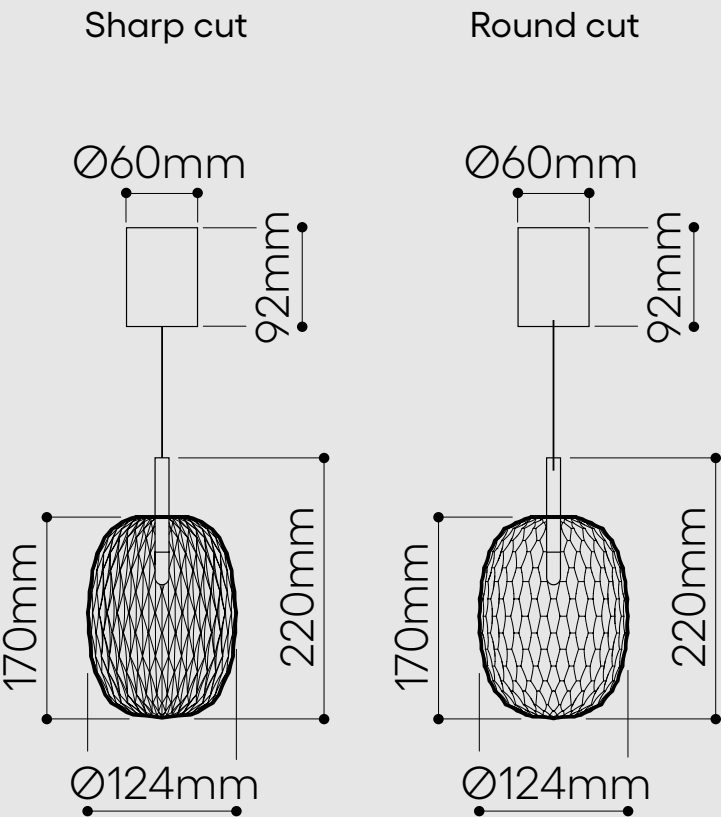

Metamorphosis bomma

LIGHTING DESCRIPTION

Size	dia 124 × H 220 dia 4,9 × H 8,7 inch
Cable	transparent 2,5 m / 98,4 inch
Weight	+ - 0,75 kg / 1,65 lb
Glass	mouth-blown lead-free crystal in clear, cigar, amber
Mounting	brushed gold (brushed brass) anthracite (brass and galvanized black nickel)
Protection	IP 20
Nominal voltage	220-240V / A.C. 50 hz (EU) 110-120 V / A.C. 60 Hz (USA)
Class	III. EU / II. USA

LIGHT SOURCE

Type	G4, 1,2W LED, 100 lm
Base	G4 (EU) / G4 (USA)
Voltage	12V, AC
Temperature	2700 K
Color index	RA 90+
Dimming	EU/Other versions - dimmable in constellations, non dimmable as a single pendant. UL/The Americas - dimmable in constellations and as a single pendant.

TRANSFORMER

Primary	100-240V, 50/60 Hz, 0,04A
Secondary	DC 700mA (0,5V–4V) 1×3W

PACKAGING

Material	Cardboard
Size	230 × 220 × 220 mm 9 × 8,6 × 8,6 inch

Origin: traditionally produced in the Czech Republic
Intellectual property license holder: Bomma Czech Republic (EU)
Represented by BMRC group s.r.o.

CERTIFICATES



METAMORPHOSIS

wall small

Design by
Rony Plesl

Handmade glass attributes

All Bomma products are hand-made from mouth-blown lead-free crystal. Therefore any small bubbles and irregularities in the glass are both a proof and a characteristic feature of this traditional craft.

The Metamorphosis Collection is produced in three colors, simply referred to as amber, smoke and clear. The clear version is made from pure crystal glass, while cigar and amber are produced from solid-color crystal. Each piece is original, thanks to the hand-cutting process. The clear and amber versions are cut using a diamond pattern, cigar is decorated with a curved geometric design. Being hand-made, the individual products can slightly differ in tone, color intensity or cut.

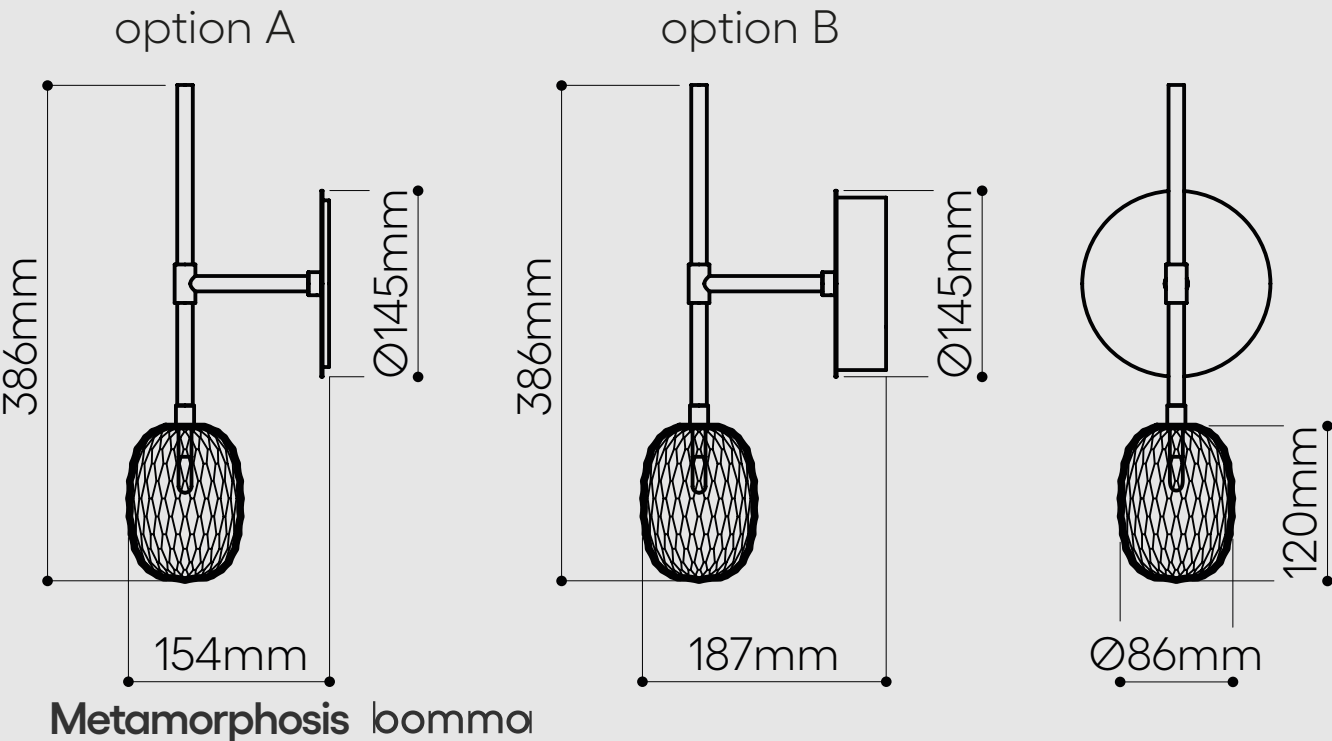

LIGHTING DESCRIPTION	
Size	86 × 154 (187) × 386 mm 3,39 × 6,06 (7,4) × 15,2 inch
Weight	+ - 1,45 kg / 3,2 lb
Glass	mouth-blown lead-free crystal in clear, cigar, amber
Mounting	brushed silver (brushed stainless steel) brushed gold (brushed stainless steel gold nitridated)
Recommended junction box	EU - A.UK1-SH (72mm dia, 60mm min. depth) UL/The Americas - electrical box, Octagon, 4 X 4 inch (1,4 inch min. depth)
Protection	IP 20
Nominal voltage	220-240V / A.C. 50 hz (EU) 110-120 V / A.C. 60 Hz (USA)
Class	II. EU / I. USA

LIGHT SOURCE	
Type	G4, 1,2W LED, 100 lm
Base	G4 (EU) / G4 (USA)
Voltage	12VDC, 100mA
Temperature	2700 K
Color index	RA 90+

Dimming	EU/Other versions - non-dimmable UL/The Americas - TRIAC, ELV
---------	--

TRANSFORMER	
Primary circuit	100-240V, 50/60 Hz,
Secondary circuit	12VDC, + - 0,5A, 5W

PACKAGING	
Material	Cardboard
Size	220 × 220 × 250 mm 8,6 × 8,6 × 9,8 inch

CERTIFICATES



METAMORPHOSIS

wall large

Design by
Rony Plesl

Handmade glass attributes

All Bomma products are hand-made from mouth-blown lead-free crystal. Therefore any small bubbles and irregularities in the glass are both a proof and a characteristic feature of this traditional craft.

The Metamorphosis Collection is produced in three colors, simply referred to as amber, smoke and clear. The clear version is made from pure crystal glass, while cigar and amber are produced from solid-color crystal. Each piece is original, thanks to the hand-cutting process. The clear and amber versions are cut using a diamond pattern, cigar is decorated with a curved geometric design. Being hand-made, the individual products can slightly differ in tone, color intensity or cut.

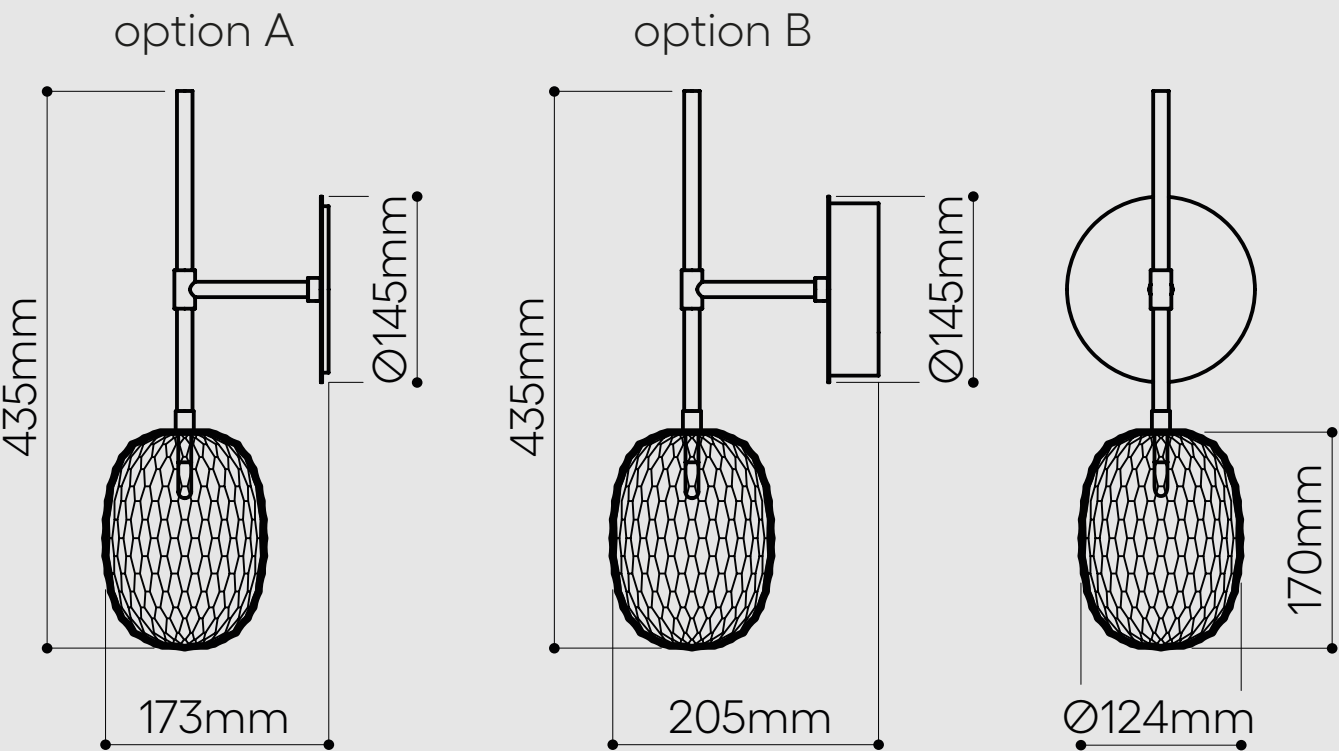

Metamorphosis bomma

LIGHTING DESCRIPTION	
Size	124 × 173 (205) × 435 mm 4,88 × 6,8 (8) × 17,13 inch
Weight	+ - 1,75 kg / 3,86 lb
Glass	mouth-blown lead-free crystal in clear, cigar, amber
Mounting	brushed silver (brushed stainless steel) brushed gold (brushed stainless steel gold nitridated)
Recommended junction box	EU - A.UK1-SH (72mm dia, 60mm min. depth) UL/The Americas - electrical box, Octagon, 4 X 4 inch (1,4 inch min. depth)
Protection	IP 20
Nominal voltage	220-240V / A.C. 50 hz (EU) 110-120 V / A.C. 60 Hz (USA)
Class	II. EU / I. USA

LIGHT SOURCE	
Type	G4, 1,2W LED, 100 lm
Base	G4 (EU) / G4 (USA)
Voltage	12VDC, 100mA
Temperature	2700 K
Color index	RA 90+

Dimming	EU/Other versions - non-dimmable UL/The Americas - TRIAC, ELV
---------	--

TRANSFORMER	
Primary circuit	100-240V, 50/60 Hz,
Secondary circuit	12VDC, + - 0,5A, 5W

PACKAGING	
Material	Cardboard
Size	220 × 220 × 250 mm 8,6 × 8,6 × 9,8 inch

CERTIFICATES



step beyond