

Frame

Tall units

Salvatore Indriolo, 2020



Tall units / Colonne / Säulen

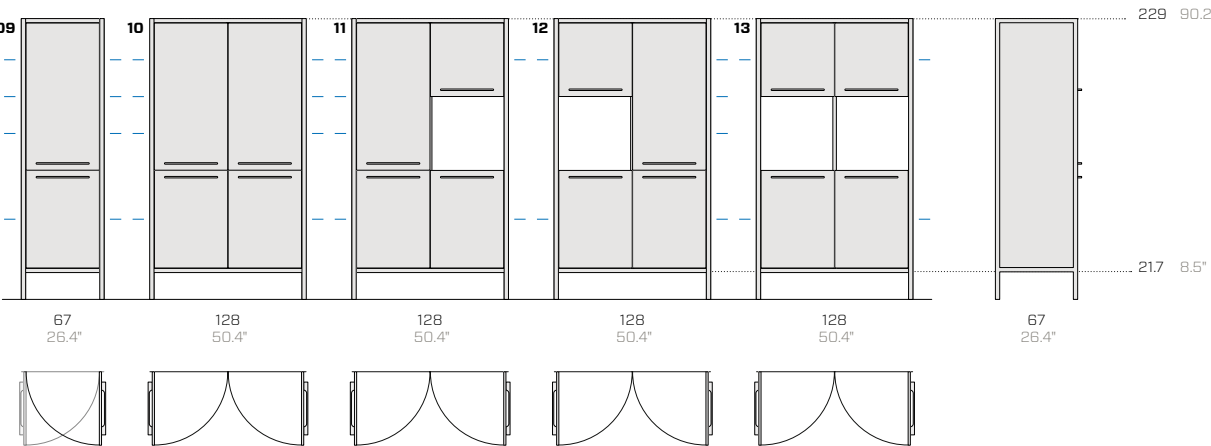
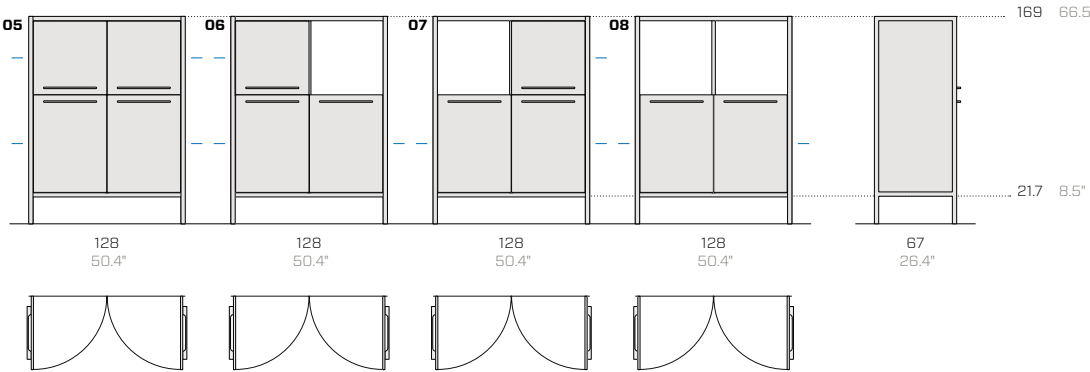
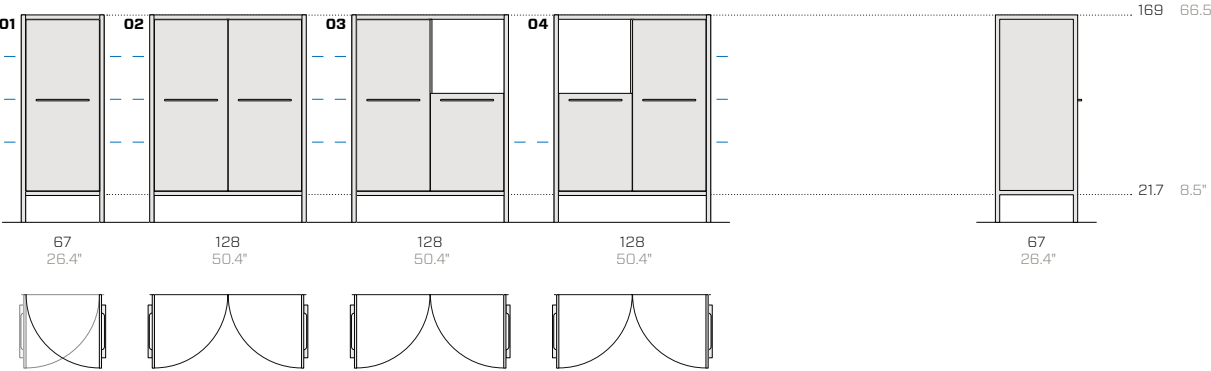

Product / Prodotto / Produkt

No.	Code	Dimensions (w-d-h)	Weight
N.	Codice	Dimensioni (l-p-h)	Peso
Nr.	Code	Abmessungen (b-t-h)	Gewicht
:	:	cm	kg

Packaging / Imballo / Verpackung

Dimensions (w-d-h)	Weight	Vol pkg
Dimensioni (l-p-h)	Peso	Vol. collo
Abmessungen (b-t-h)	Gewicht	Vol. Kollo
cm	kg	mc

Tall units / Colonne / Säulen

01	FRC142	68	67	169	84	200	80	55	99	0.90
02	FRC149	128	67	169	135	200	80	55	170	0.90
03	FRC147	128	67	169	125	200	80	95	160	1.60
04	FRC148	128	67	169	125	200	80	95	160	1.60
05	FRC143	128	67	169	140	200	80	95	175	1.60
06	FRC144	128	67	169	130	200	80	95	165	1.60
07	FRC145	128	67	169	130	200	80	95	165	1.60
08	FRC146	128	67	169	125	200	80	95	160	1.60
09	FRC150	68	67	229	110	240	80	95	150	1.90
10	FRC152	128	67	229	175	240	80	95	220	1.90
11	FRC153	128	67	229	165	240	80	95	210	1.90
12	FRC154	128	67	229	165	240	80	95	210	1.90
13	FRC155	128	67	229	160	240	80	95	205	1.90

Back panel for freestanding tall unit / Schiena per colonna freestanding / Rückwand für freistehende Säule

-	FRK70F1	60	3	140	7	144	64	7	8	0.10
-	FRK71F2	120	3	140	14	144	124	7	15	0.20
-	FRK72F1	60	3	200	10	204	64	7	12	0.10
-	FRK73F2	120	3	200	20	204	124	7	22	0.20

Floor attachment cover kit / Kit di copertura allacciamenti a pavimento / Set für Abdeckung der Anschlüsse am Boden

-	FRK03A1	60	20	25	3	62	22	27	5	0.10
---	---------	----	----	----	---	----	----	----	---	------



Drawer kits / Kit cassetti / Schubladen-Set

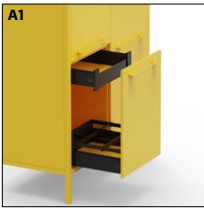
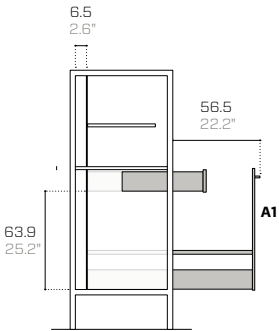

Kit 1 large drawer
Kit 1 cassettone
Set 1 Kommode

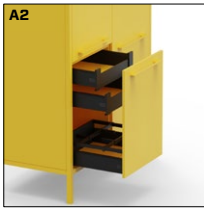
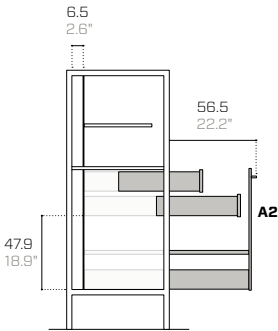

Kit 2 drawers
Kit 2 cassetti
Set 2 Schubladen

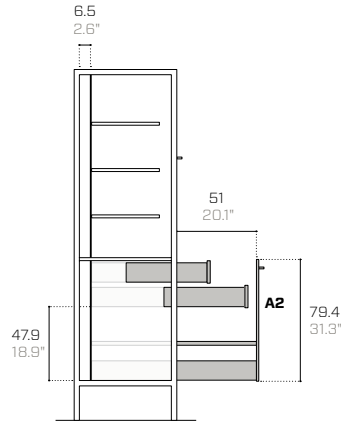
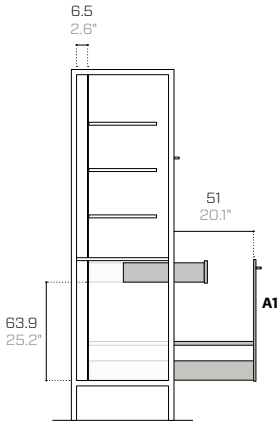

Appliances and accessories / Elettrodomestici e accessori / Haushaltsgeräte und Zubehör

BARAZZA	ELECTROLUX	AEG
B1 	B2 	B3
Ovens Forni Öfen		

AEG		
C1 	C2 	C3
Microwave Microonde Microwelle	Coffee maker Macchina del caffè Kaffeemaschine	Wine cooler Cantina Weinkühlschrank

Integrated small drawer
Cassettino integrato
Integrierte Klein Schublade

ELECTROLUX	AEG
D1 	D2
	72 28.3"
	4 1.6"
Dishwashers Lavastoviglie Geschirrspüler	

ELECTROLUX		AEG	
E1 	E2 	E3 	E4
139.4 54.9"			199.4 78.5"
Refrigerators Frigoriferi Kühlschränke			

Product / Prodotto / Produkt							Packaging / Imballo / Verpackung				
No.	Code	Brand code	Dimensions (w-d-h)			Weight	Dimensions (w-d-h)			Weight	
N.	Codice	Codice marca	Dimensioni (l-p-h)			Peso	Dimensioni (l-p-h)			Peso	
Nr.	Code	Herstellercode	Abmessungen (b-t-h)			Gewicht	Abmessungen (b-t-h)			Gewicht	
:	:	:	cm			kg	cm			kg	
Drawer kits (surcharge on the door price) / Kit cassetti (sovrapprezzo costo anta) / Schubladen-Set (Zuschlag auf den Türpreis)											
A1	FRK50C2	-	60	55	79.4	19	63	58	63	20	
A2	FRK51C3	-	60	55	79.4	24	63	58	63	25	
Aluminum cutlery dividers / Divisori portaposate in alluminio / Besteckteileiler aus aluminium											
-	FRK09DP	-	48	8	5	1	50	10	6	1	
Waste separation systems / Kit di contenitori per raccolta differenziata / Abfalltrennsystem											
-	FRK61DIF	-	44	29	22	3	50	10	6	1	
-	FRK60DIF	-	46	30	30	2	50	10	6	1	
Additional shelf / Ripiano aggiuntivo / Zusätzlicher Einlegeboden											
-	FRK10R1	-	57	46	2	3	50	10	6	3	
Ovens (with installation kit) / Forni (con kit di installazione) / Backofen (mit Bausatz)											
B1	FRB02V	1FUNPV	60	61	60	35	64	64	68	39	
B2	FRE03	FQ203IXEV	60	60	55	33	64	64	68	37	
B3	FRE05	BEK455220M	60	60	55	33	64	64	68	37	
Appliances (with installation kit) / Elettrodomestici (con kit di installazione) / Haushaltselektrogeräte (mit Bausatz)											
C1	FRE11	MBE2658DEM	60.0	53	60	28	66	54	53.0	31	
C2	FRE12	KKK884500M	60.0	53	60	28	66	54	53.0	31	
C3	FRE13	KWK884520M	60.0	53	60	28	66	54	53.0	31	
D1	FRE25	KESC5300L	54.6	55	76	35	60	68	85.5	38	
D2	FRE29	FSE63307P	54.6	55	76	35	60	68	85.5	38	
Refrigerators (with installation kit) / Frigoriferi (con kit di installazione) / Kühlschränke (mit Bausatz)											
E1	FRE23	KFB1AF12S	54	55	122	25	59	60	130	30	
E2	FRE27	SFB612F1AS	54	55	122	25	59	60	130	30	
E3	FRE24	FI22/11V	54	55	178	45	59	60	184	50	
E4	FRE28	SCK618F3FS	54	55	178	45	59	60	184	50	

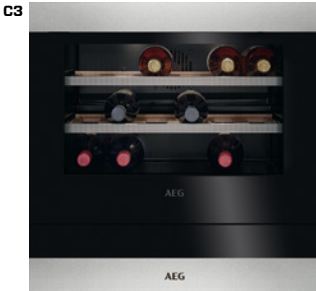

Metal essentials

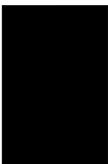

01.18
Black (RAL 9005)
Nero / Schwarz

EM ▲ ■
MT



08.20
Rose quartz
Rosa quarzo / Rosenquarz

EM ▲



15.19
Forest green (RAL 6007)
Verde bosco / Waldgrün

EM ▲ ●



02.18
Anthracite (RAL 7021)
Antracite / Anthrazit

EM ▲ ■
MT



09.18
Ruby red (RAL 3003)
Rosso rubino / Rubinrot

EM ▲



16.19
Turquoise blue (RAL 5018)
Blu turchese / Türkisblau

EM ▲

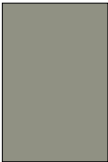

03.18
Fantin grey
Grigio Fantin / Fantin-Grau

EM ▲ ■



10.21
Flame red (RAL 3000)
Rosso fuoco / Feuerrot

EM ▲ ●



17.18
Pastel blue (RAL 5024)
Blu pastello / Pastellblau

EM ▲
MT



04.18
Light grey (RAL 7035)
Grigio luce / Lichtgrau

EM ▲ ■
MT



11.21
Melon yellow (RAL 1028)
Giallo melone / Melonengelb

EM ▲ ●



18.21
Dusty blue (RAL 5014)
Azzurro polvere / Staubiges blau

EM ▲ ●



05.19
Cloud grey
Grigio nuvola / Wolkengrau

EM ▲ ■

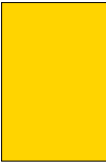

12.19
Zinc yellow (RAL 1018)
Giallo zinco / Zinkgelb

EM ▲



19.18
Gentian blue (RAL 5010)
Blu genziana / Enzianblau

EM ▲ ●
MT



06.18
White (RAL 9016)
Bianco / Weiß

EM ▲ ■
MT



13.21
Pastel green (RAL 6019)
Verde pastello / Weißgrün

EM ▲ ●



20.19
Steel blue (RAL 5011)
Blu acciaio / Stahlblau

EM ▲



07.21
Milk white (RAL 9001)
Bianco latte / Milchweiß

EM ▲ ● ■
MT



14.18
Sage green (RAL 6021)
Verde salvia / Salbeigrün

EM ▲ ●
MT



21.21
Coffee brown (RAL 8019)
Marrone caffè / Kaffeebraun

EM ▲

Metal design

Metallic



41.18
Gold
Oro / Gold

EM ▲



43.21
Bronze
Bronzo / Bronze

EM



47.21
Platinum
Platino / Platin

EM ▲



46.21
Titanium
Titanio / Titan

EM ▲



45.21
Silver
Argento / Silber

EM ▲



44.18
Iron
Ferro / Eisen

EM ▲



42.19
Rust
Ruggine / Rost

EM ▲●

Earth

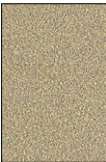

51.18
Sand
Sabbia / Sand

EM ▲●



57.21
Clay
Creta / Lehm

EM ▲●



52.18
Moss
Muschio / Moos

EM ▲●



53.18
Basalt
Basalto / Basalt

EM ▲●



54.18
Stone
Pietra / Stein

EM ▲●



55.18
Amethyst
Ametista / Amethyst

EM ▲



56.21
Ocean
Oceano / Ozean

EM ▲

Surfaces / Superfici / Oberflächen

EM Embossed / Goffrato / Gaufriert
MT Matt / Opaco / Matt

Use / Utilizzo / Verwenden

- ▲ Tops / Top / Arbeitsplatte
- Outdoor / Esterni / Außenbereich
- Food / Alimentare / Lebensmittel

Technical information

Metal Non-toxic powder coating for interior use, with no heavy metals. Cured in an oven at 190°C, following degreasing and phosphating. Guaranteed minimum thickness of 50 microns. Minimum resistance to salt spray of 200 hours (in accordance with the ASTM B117 standard). Some finishes are suitable for direct contact with food as required by Italian Law Decree D.M. 21/03/73 and subsequent updates. Requests for other RAL finishes can be considered.

Informazioni tecniche

Metallo Verniciatura per interni a polveri atossiche prive di metalli pesanti, con passaggio in forno a 190 °C, previo trattamento di sgrassaggio e fosfatazione. Spessore minimo garantito 50 micron, resistenza minima in nebbia salina pari a 200 ore (norma ASTM B117). Alcune finiture sono idonee al contatto diretto con alimenti come previsto dal decreto italiano D.M. 21/03/73 e successivi aggiornamenti. Altre finiture RAL valutabili su richiesta.

Technische Informationen

Metall Die Pulverbeschichtung der gift- und schwermetallfreien Pulverlacke für Innenbereiche erfolgt im Lackierofen bei 190 °C nach vorheriger Entfettung und Phosphatierung. Die garantierte Mindeststärke der Lackschicht beträgt 50 Mikron bei einer Mindestprüfungsdauer von 200 Stunden im Salznebel (ASTM-Norm B117). Einige Oberflächen sind für den direkten Kontakt mit Lebensmitteln geeignet, wie in der Verordnung vorgesehen Italienisch D.M. 21/03/73 und folgende Aktualisierungen. Auf Anfrage können andere RAL-Finishes in Betracht gezogen werden.

Frame columns are available in two heights and in two widths, and can be fitted with doors, drawers and appliances, with no compositional limits.

Frame made of 35 x 35 mm (1.38" x 1.38") square tubes. Concealed adjustable feet.

Doors inset in the frame, made of bent and filled sheet metal. Door thickness: 20 mm (0.79"). Metal handles with a coating in a colour to match the doors. Soft-close dampening hinges. Door opening 95°.

Drawers with fronts inset in the frame, made of bent and filled sheet metal. Drawer front thickness: 20 mm (0.79"). Metal handles with a coating in a colour to match the drawer fronts. Drawers with Hettich runners and built-in stabilization and soft-close systems. Capacity: 40 kg (88.18 lb).

Sides and bases inset in the frame, made of bent sheet metal; filled sides.

Optional backs in metal, flush to the frame.

Internal shelves made of bent sheet metal.

Optional appliances with custom installation kit, from AEG, Barazza, Electrolux.

The product requires assembly.

Le colonne Frame sono proposte in due altezze e in due larghezze, e possono essere dotate di ante, cassetti ed elettrodomestici, senza limiti compositivi.

Telaio in tubolare quadrato 35 x 35 mm (1.38" x 1.38"). Piedini invisibili regolabili.

Ante in luce al telaio, in lamiera piegata e tamponata. Spessore delle ante 20 mm (0.79"). Maniglie in metallo verniciate in tinta con le ante. Cerniere ammortizzate. Apertura ante 95°.

Cassetti con frontali in luce al telaio spessore 20 mm (0.79"), in lamiera piegata e tamponata. Maniglie in metallo verniciate in tinta con i frontali dei cassetti. Cassetti con guide Hettich, sistemi di stabilizzazione e soft-close integrati con portata 40 kg (88.18 lb).

Fianchi e fondi in luce al telaio, in lamiera piegata; fianchi tamponati.

Schiene opzionali in metallo in luce al telaio.

Ripiani interni in lamiera piegata.

Elettrodomestici opzionali – con kit di installazione personalizzato – AEG, Barazza, Electrolux.

Il prodotto viene fornito smontato.

Frame-Hochschränke sind in zwei Höhen und in zwei Breiten erhältlich, und können mit Türen, Schubladen und Geräten ausgestattet werden, wobei es keine kompositorischen Grenzen gibt.

Gestell aus Vierkantrohr 35 x 35 mm (1.38" x 1.38"). Unsichtbare, einstellbare Füße.

Türen aus gedämmtem Falzblech, bündig mit dem Gestell. Stärke der Türen 20 mm (0.79"). Pulverbeschichtete Metallgriffe gleichfarbig mit den Türen. Gedämpfte Scharniere. Türen öffnen 95°.

Schubladen aus gedämmtem Falzblech, mit Fronten bündig mit dem Gestell. Schubladenfrontstärke: 20 mm (0.79"). Pulverbeschichtete Metallgriffe gleichfarbig mit den Schubladenfronten. Schubladen mit Führungsschienen Hettich mit Stabilisations- und Soft-Close-Systemen und mit einer Tragfähigkeit von 40 kg (88.18 lb).

Seiten und Basen aus Falzblech, bündig mit dem Gestell; bündig Seiten.

Optionale Rückwände aus Metall, bündig mit dem Gestell.

Innere Einlegeböden aus Falzblech.

Optionales Haushaltsgeräte mit benutzerdefiniertes Bausatz, von AEG, Barazza, Electrolux.

Das Produkt erfordert eine Montage.

Disclaimer / Esclusione di responsabilità / Haftungsausschluss

Fantin Srl reserves the right to change the dimensions and features of the products contained in this technical data sheet at any time and without prior notice. The finishes illustrated are purely indicative as the accuracy tolerances of printing processes should be taken into account.

Fantin Srl si riserva la facoltà di modificare in qualsiasi momento e senza preavviso le dimensioni e l'esecuzione dei prodotti contenuti nella presente scheda tecnica. Le finiture riportate hanno valore indicativo in quanto soggette alle tolleranze dei processi di stampa.

Fantin Srl behält sich das Recht vor, die angegebenen Maße und Ausführungen der Produkte, welche dieses Produktblatt enthält, jederzeit ohne Vorankündigung zu ändern. Aufgrund drucktechnischer Abweichungen dienen die dargestellten Ausführungen nur der Illustration.

Fantin Srl

via San Vito, 43
33080 - Bannia
di Fiume Veneto (PN)
Italia

t +39 0434 959 133
f +39 0434 560 037
fantin@fantin.com
www.fantin.com



UNI EN ISO 9001