

## IMAGE



## SPECIFICATION

Upholstery Available In Fabric or Leather  
 Available C.O.M. / C.O.L.

Required Fabric For Upholstery: 1,49 Lm / 4.89 ft  
 Required Leather For Upholstery: 2,43 Sq m / 26.16 ft<sup>2</sup>

Gross Weight: 17,60 Kg / 38,50 lb  
 Volume: 0,43 Cbm / 15.18 ft<sup>3</sup>  
 Box Dimensions: w 1330 x d 600 x h 540 mm / 52.36" x 23.62" x 21.26"  
 1 per box  
 HARMONIZED SYSTEM CODE 94016100

## ROUGH-IN DRAWING

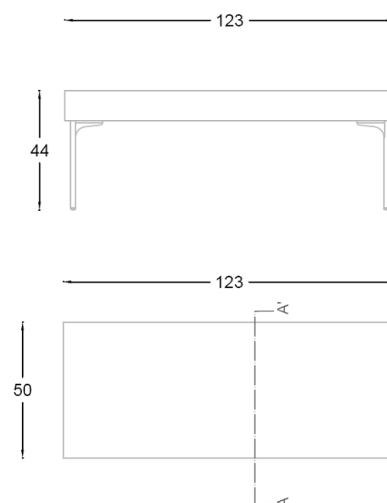

## STANDARD FEATURES

### LEGS FRAME

Steel legs, round section 18 mm diameter. Anti-slip nylon glides assembled, suitable for any type of flooring.  
 Frame finish: chromium plating, average thickness 25 microns, or embossed epoxy-polyester powder coating, with double coat anti-scratch treatment average thickness 50 microns.

### SEAT INNER FRAME

Inner structure in stratified beech plywood 18 mm thickness.

### UPHOLSTERY

Foam made of flexible crushproof polyurethane resin ELAST PERFORMANCE characterized by "smart memory", that allows the armchair to recover the initial support even after long and strong pressure. Seat, backrest and armrests padding in differentiated density polyurethane foam. Wadding on seat and back 100 gr/Sq m. CFC-free.

### PILLOWS

Cushions with mixed feather padding. Available in three different sizes: 450 x 270 mm - 350 x 350 mm - 540 x 180 mm.

### LINKING DEVICE

Metal Junction mechanism and plate. Required two units to connect two modules.

Available FSC® certified

## COUNTRY OF PRODUCTION:

Italy

## ENVIRONMENT:

Indoor

## WARRANTY:

10 years

## OTHERS

-Stitching's Are Made With Continuous Filament Polyester Thread With A Water Repellent Finish Made By Coats® Type Weaverbird™ This Type Of Lubricated Polyester (Tkt 010) Thread Make The Stitching Stronger, Resistant To The Abrasion, And Gives The Product More Tailoring Appearance. Allowing To Read The Forms And Design Of The Product  
 -All screws and assembly systems used in the production of Sitia's product are UNI EN ISO 9001-2000 and UNI ISO/TS 16949 process certified

Sitia srl Copyright 2020 - all rights reserved. The described data could be modified without prior communication

Sitia srl · via G. Matteotti 6 36056 · Tezze sul brenta Vicenza Italy  
 t +39 0 424 898497 | t +39 0 424 898382 | f +39 0 424 1700102 · [www.sitia.com](http://www.sitia.com) [info@sitia.com](mailto:info@sitia.com)

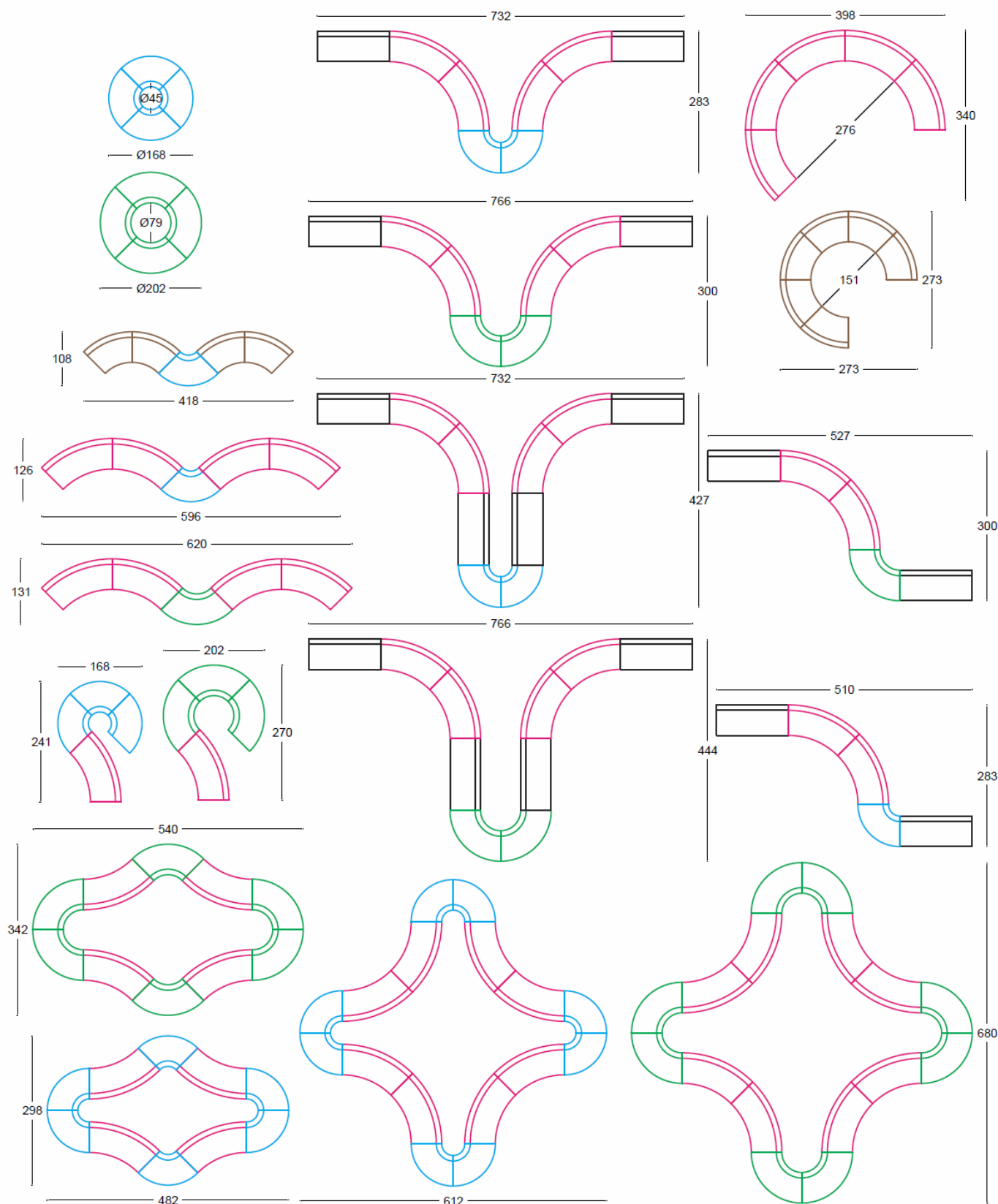
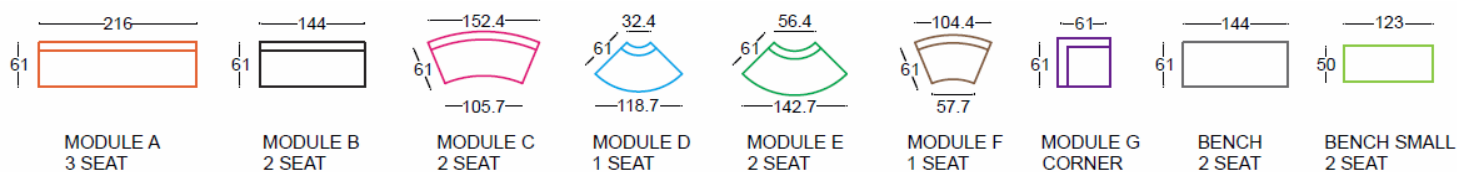

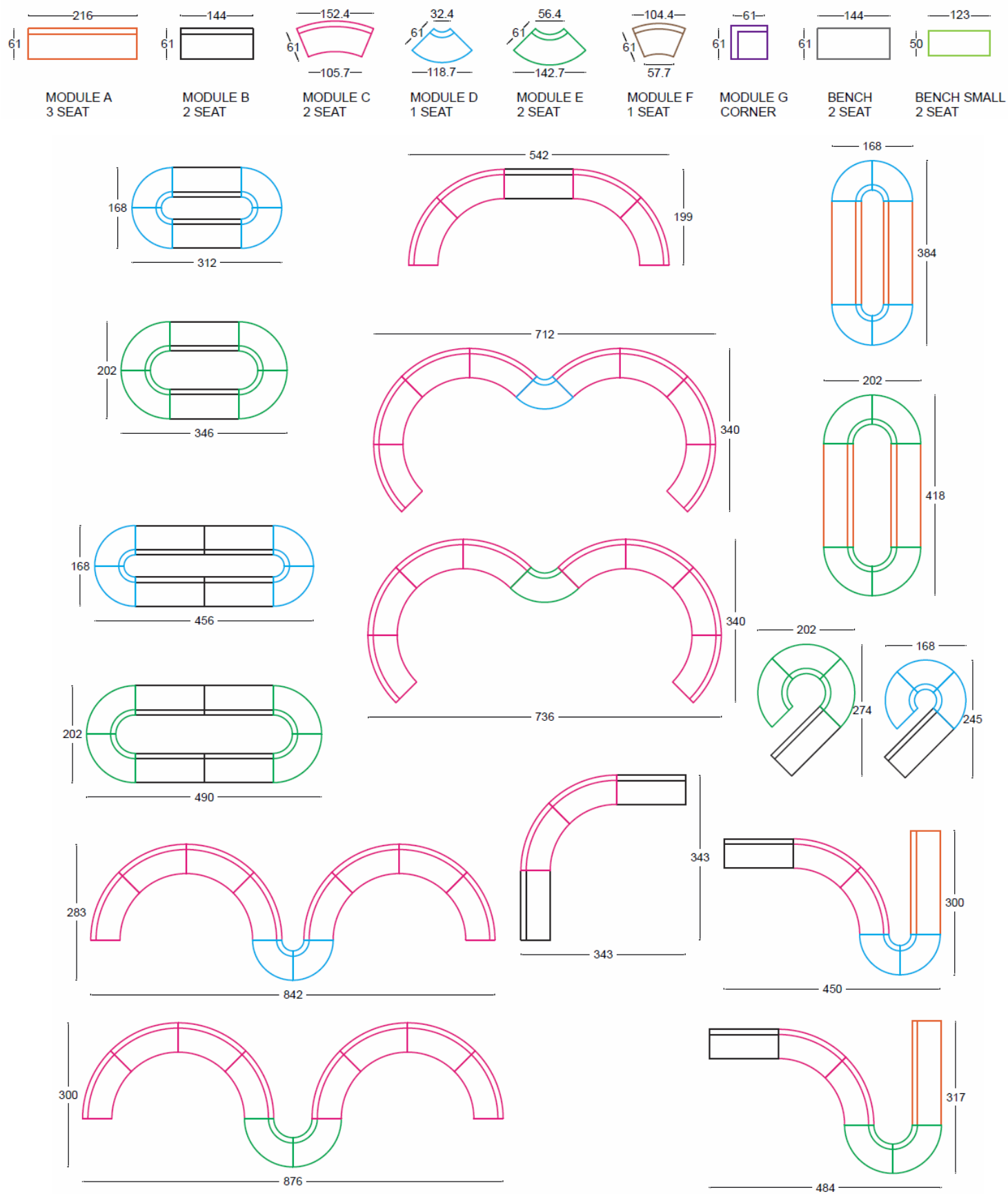

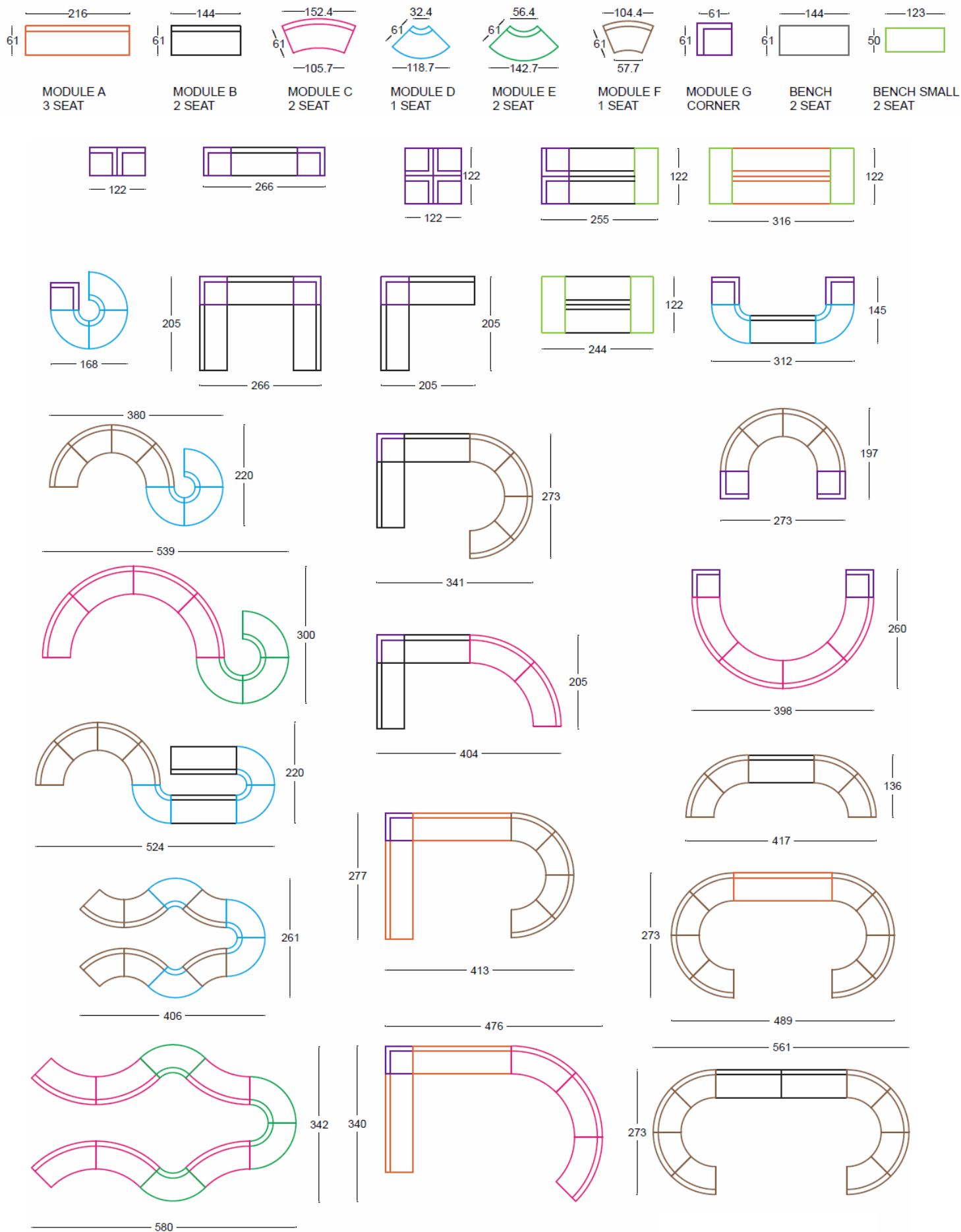

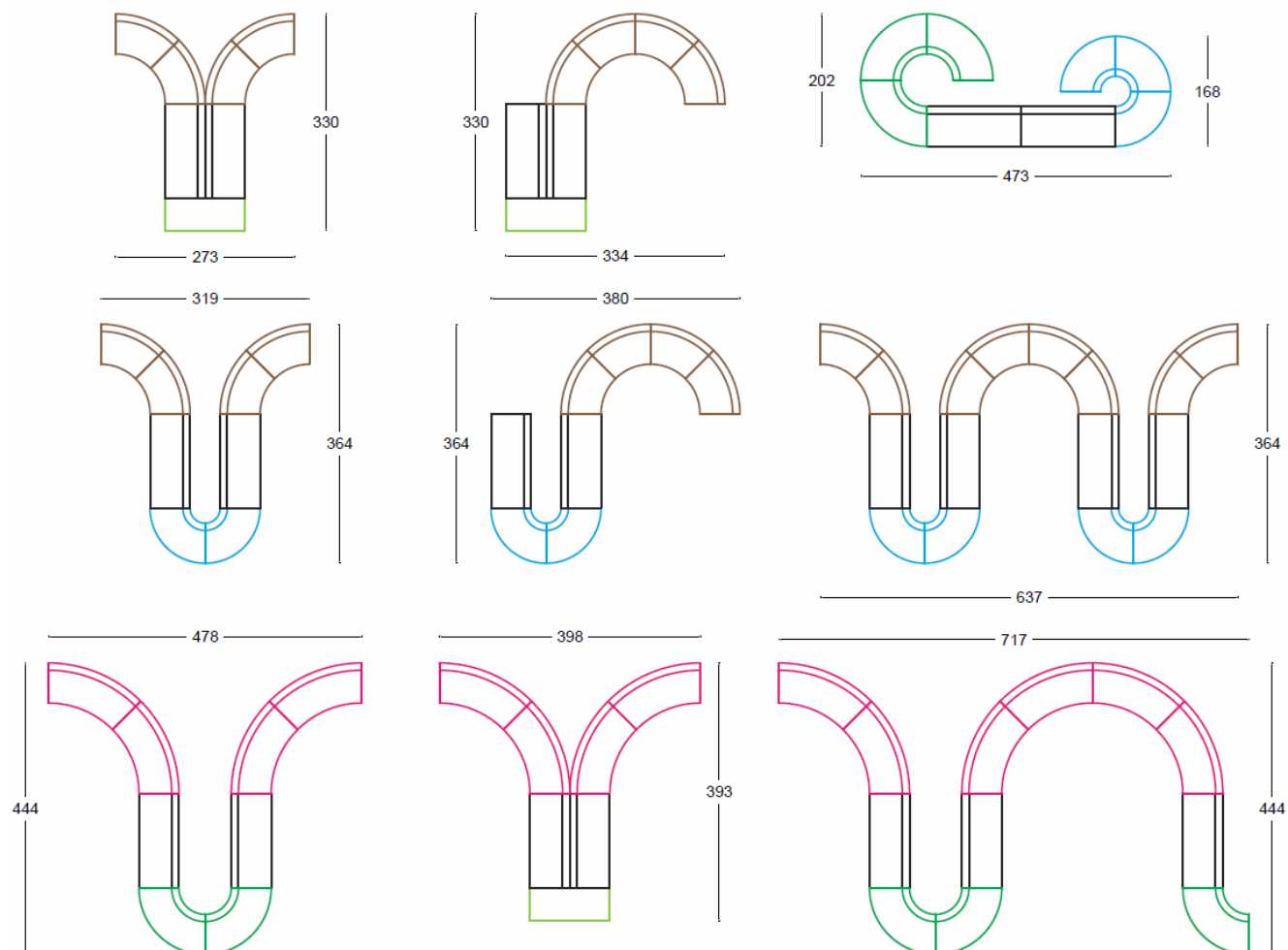
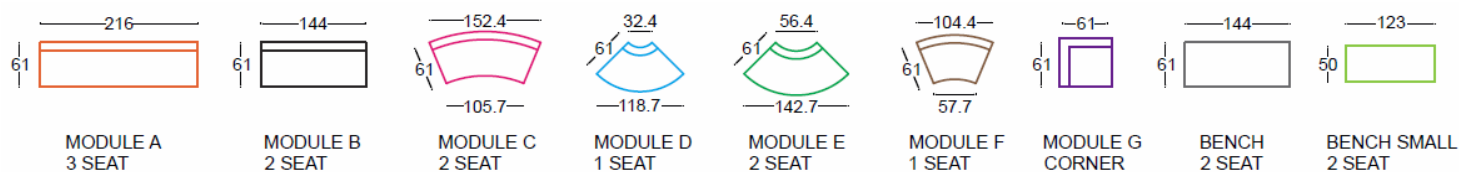

## Vis-à-vis:

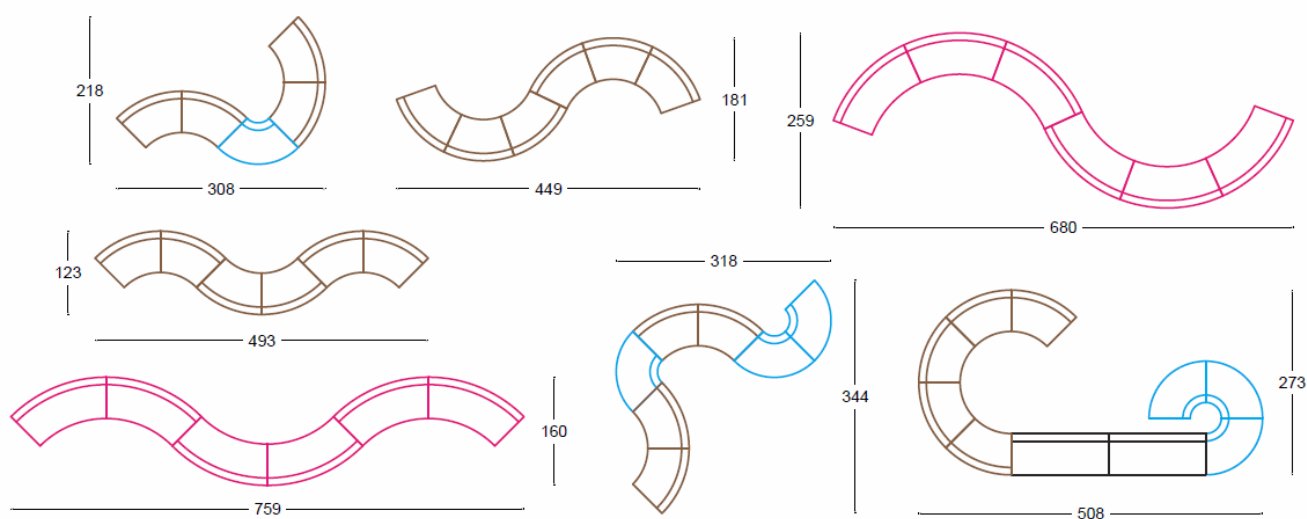

# sitalia

MODEL LAGUNA  
DESIGN ELENA TREVISAN



A'DESIGN AWARD  
WINNER 2018  
SILVER

