

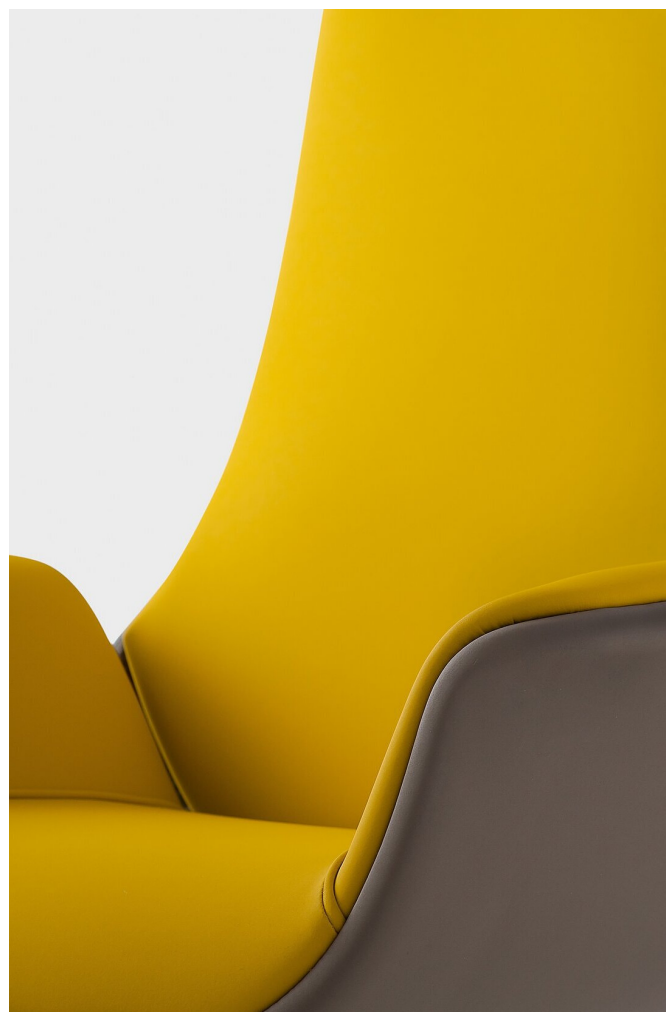

Upholstered executive armchair

Executive armchair with seat and backrest in curved beech-wood multilayer and padding in non-deformable expanded polyurethane. Seat-back connection block made of steel. Mechanism with steel body integrated in the seat, cover and control levers in technopolymer, or fixed steel plate with lever. Bases in polypropylene or aluminium on swivel castors.



TYPES



Flat padding



Padding with capitonné stitching



One colour



Two colours

The first code refers to the seat and backrest. The second code refers to the external parts of the armchair.

HIGH BACKREST WITH WINGS

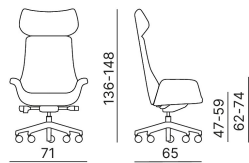

Padded arms



HIGH BACKREST WITHOUT WINGS

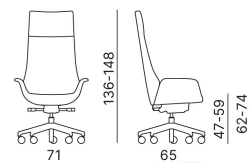

Padded arms



MEDIUM BACKREST

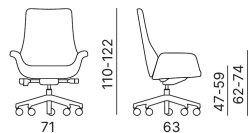

Padded arms



ARMS



Padded arms

Integrated into the seat

ADJUSTMENTS

ADJUSTMENTS



Gaslift plate (GP)
Seat height adjustment

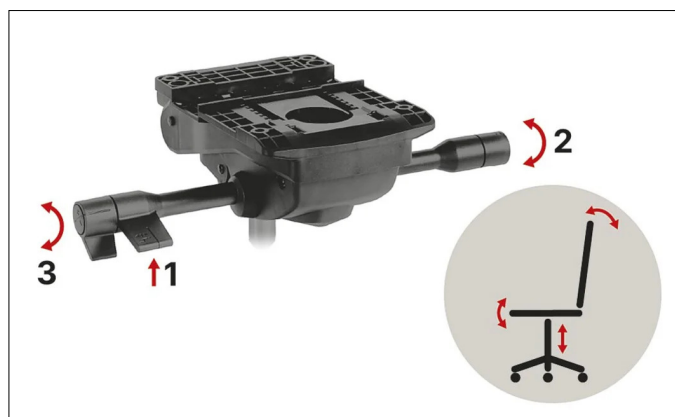

Synchron (C)
Seat and backrest tilt synchron mechanism with tension adjustment and seat height adjustment

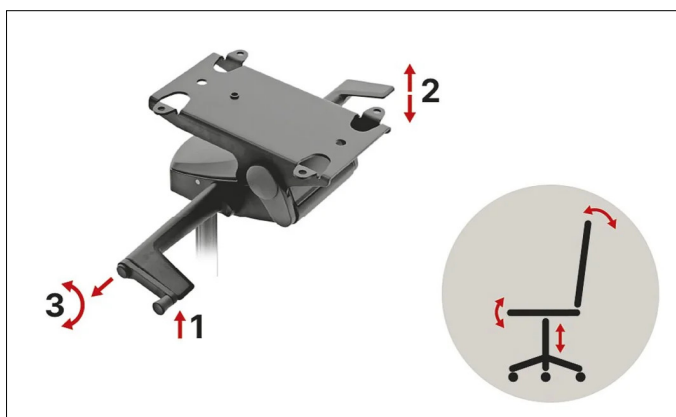

"Knee tilt" (M)
Seat and backrest tilt mechanism with advanced point tilting, tension adjustment and seat height adjustments

1. Seat height adjustment
2. Tilt movement control
3. Tension adjustment

5-STAR SWIVEL BASES



APS (Ø 660)
Black nylon base
With rubber self-braking castors Ø65 mm
040108



APN (Ø 670)
Steel base with black polypropylene guard
With rubber self-braking castors Ø50 mm
040080



APW (Ø 675)
White nylon base
With rubber self-braking castors Ø65 mm
040108

5-STAR SWIVEL BASES

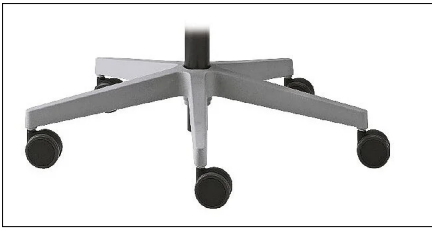

APG (Ø 675)
Grey nylon base
With rubber self-braking castors Ø65 mm
040108



AL6 (Ø 654)
Polished aluminium base
With rubber self-braking castors Ø65 mm
040108



AL7 (Ø 675)
Polished aluminium base
With rubber self-braking castors Ø50 mm
040081



ANN (Ø 654)
Black painted aluminium base
With rubber self-braking castors Ø65 mm
040108



AWW (Ø 654)
White painted aluminium base with white castors and gaslift
With white rubber self-braking castors Ø65 mm **041400**



AL5 (Ø 654)
Polished aluminium base with chromed castors and gaslift
With chromed rubber self-braking castors Ø65 mm **040109**



AL3 (Ø 654)
Polished aluminium base with chromed castors and gaslift
With chromed rubber self-braking castors Ø65 mm **040109**



AL4 (Ø 730)
4-star polished aluminium base with chromed feet
(Do not use on tilt versions)

CASTORS AND FEET



040108
Rubber self-braking castors Ø65 mm



040109
Rubber self-braking chromed castors Ø65 mm (for base AL3-AL5)



040080
Rubber self-braking castors Ø50 mm (only for APN base)



040081
Rubber self-braking castors Ø50 mm (only for AL7 base)



041400
Rubber self-braking white castors Ø65 mm (for AWW base)



0401430
ON REQUEST - Black rubber self-braking hollow castors Ø65 mm (only for base: APS-APG-APW-AL6-ANN-AL5-AL3-AWW)



099578
ON REQUEST - Black nylon foot (only for base: APS-APG-APW-AL6-ANN-AL5-AWW)



049578
ON REQUEST - Black nylon foot (only for base: APN-AL7)

CASTORS AND FEET

Note for castors:

- Suitable for hard floors, parquet and tiles EN1335-2
- With silent pin (except for castors 040080-040081)

INFO



NOTES

TWO COLOURS: The first code refers to seat and back. The second code refers to the external part of the armchair.



TECHNICAL SPECIFICATIONS

- EN1335 tipo C
- Product tested in accordance with the current edition at the time of testing



FIRE RESISTANCE ITALIAN HOMOLOGATION

- Class 1IM: Only on request with upholstery: Trevi cat. C