

Morphed Mirror
Design Paul Cocksedge, 2025

Wall mirror.

Mirror with protective back film. Shelf in solid ash.
Supplied with brackets for wall hanging.
The mirror can be hung on both short sides.

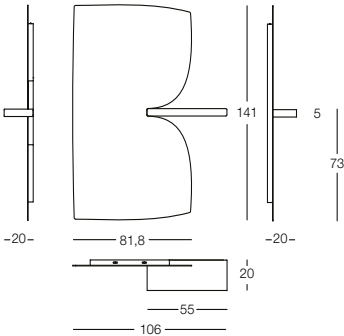
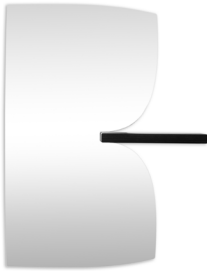

7009.92.00	0,285m³ 150x90x20	20,00 kg 17,00 kg
------------	----------------------	----------------------

Art. nr.	Shelf in solid ash
AC585	black

Wall mirror.

Mirror with protective back film. Shelves in solid ash.
Supplied with brackets for wall hanging.

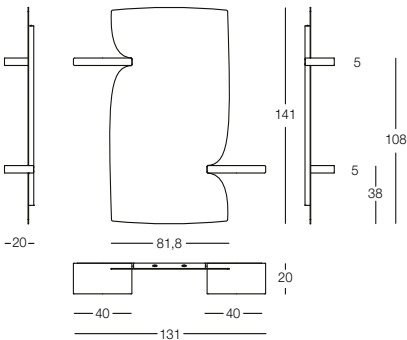
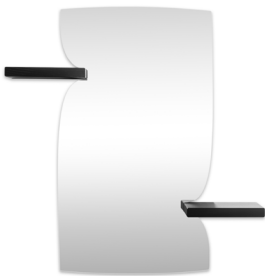

7009.92.00	0,285m³ 150x90x20	20,00 kg 17,00 kg
------------	----------------------	----------------------

Art. nr.	Shelves in solid ash
AC580	black

Shelf in solid ash

