

NOVA Wood meeting and coffee tables



FEATURES

- Easy to assemble and disassemble - "metal to metal" construction
- Just one tool for assembling (DIN911 S5)
- Bolted connections (without screws)

QUALITY STANDARD

- LST EN 527-1:2011
- LST EN 527-2:2003
- All desks meet the requirements of the LST EN 527-3:2003 standard

TECHNICAL INFORMATION

Tabletop

- 25 mm MFC (melamine) with 2 mm ABS edging;
- 26 mm MDF covered in HPL with sloping painted edges;
- Sloping painted edges: white or black colour;
- The corners of sloping desktop are rounded: R100 mm;
- 10 mm gap between the legs and the desktop.

Central leg (solid wood leg fixed into metal tube)

- Lacquered and stained natural ash solid wood;
- Glued wood construction;
- With metal inserts for fixing;
- Plastic feet with height levelling (+10 mm);
- Metal tube: 80x40 mm, powder coated metal.

Metal beam

- Metal tube - 40x20 mm;
- With welded metal plates for leg fixing;
- Powder coated metal.

Legs (coffee tables)

- Lacquered and stained natural ash solid wood;
- Glued wood construction;
- Powder coated metal;
- Plastic feet with height levelling (+10 mm).

Legs (meeting tables)

- Lacquered and stained natural ash solid wood;
- Glued wood construction;
- With metal inserts for fixing;
- Plastic feet with height levelling (+10 mm).



Electrical and cable management

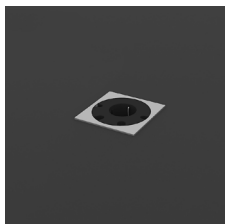

With Götessons power sockets



With insert and Götessons power sockets



With insert and grommets for wire management

Edge type



ABS edge (melamine)

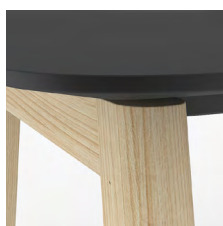

Sloping edge (HPL)

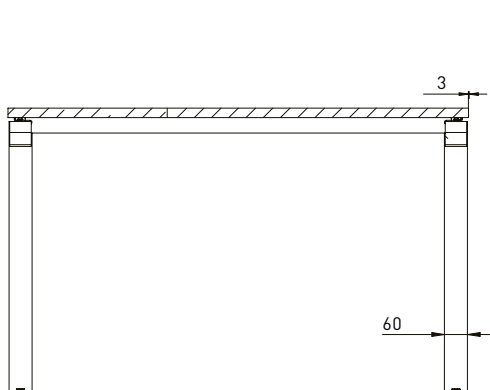

Table with melamine tabletop

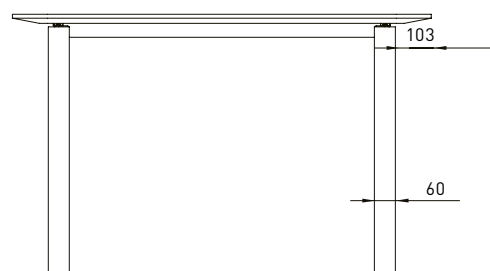

Table with HPL tabletop

Inserts

- Lacquered and stained;
- 25 mm chipboard covered in ash wood veneer with 1.5mm edging (for plain edges desktops);
- 26mm MDF covered in ash wood veneer with 1.5mm edging (for sloping edges desktops).

Grommets

- Lacquered and stained;
- 9mm MDF covered in ash wood veneer with painted edges.

Cable tray (included)

- Dimensions: 500x100, H=110mm (except for CNM182 and CNM185: 1100x100, H=110 mm);
- Matches the colour of frame.

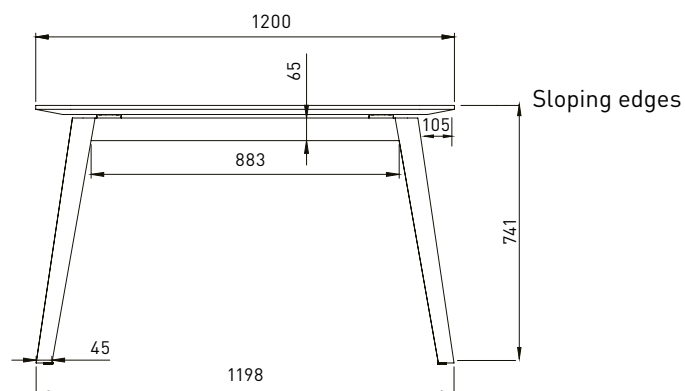
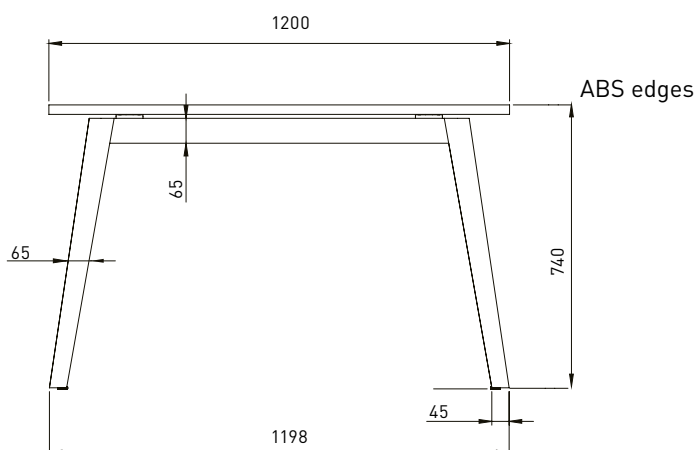

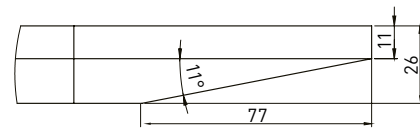
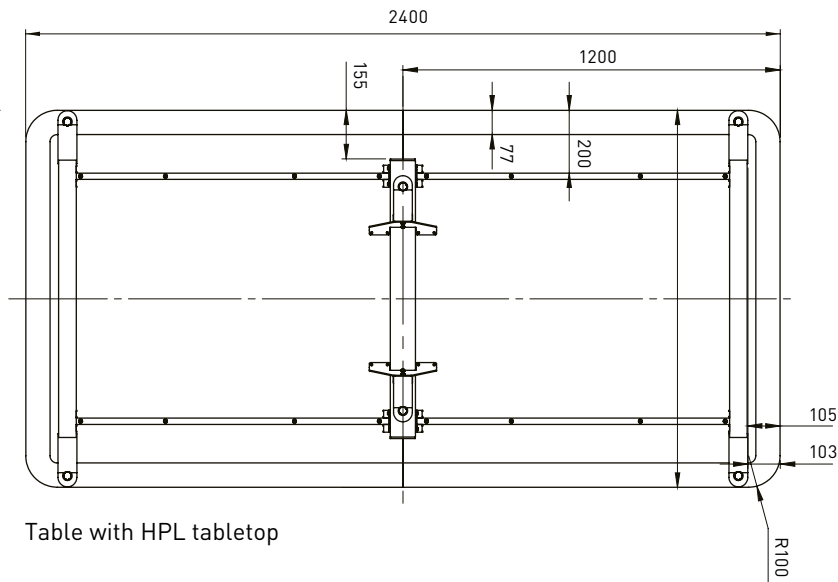

Sloping edge

MATERIALS

- Melamine: M1 (white), M1D2 (white with amber oak edges), N (grey);
- HPL: M1B02 (white with white painted edges), M1B01 (white with black painted edges), L6B01 (black with black painted edges);
- Metal: E (white), A (black), M (metallic), T1 (dark grey);
- Solid wood: W2 (ash stained light grey).

GUARANTEE

- 5 years

RANGE

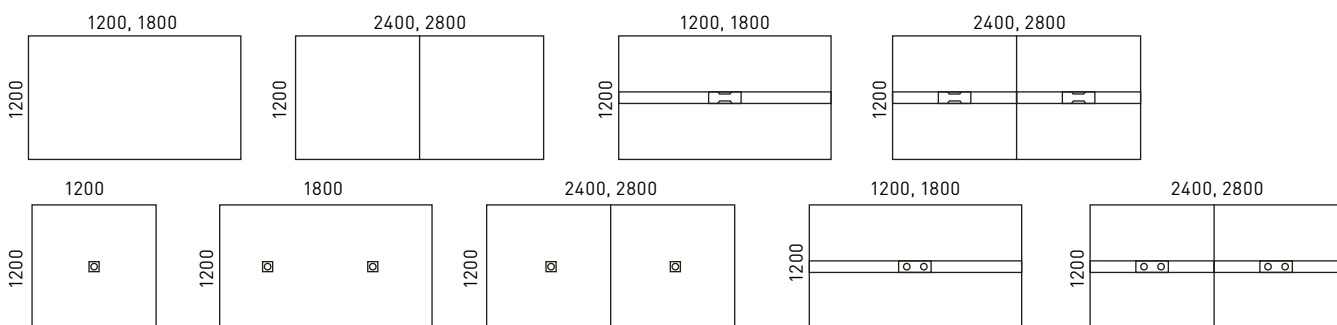

Meeting tables with melamine tabletop

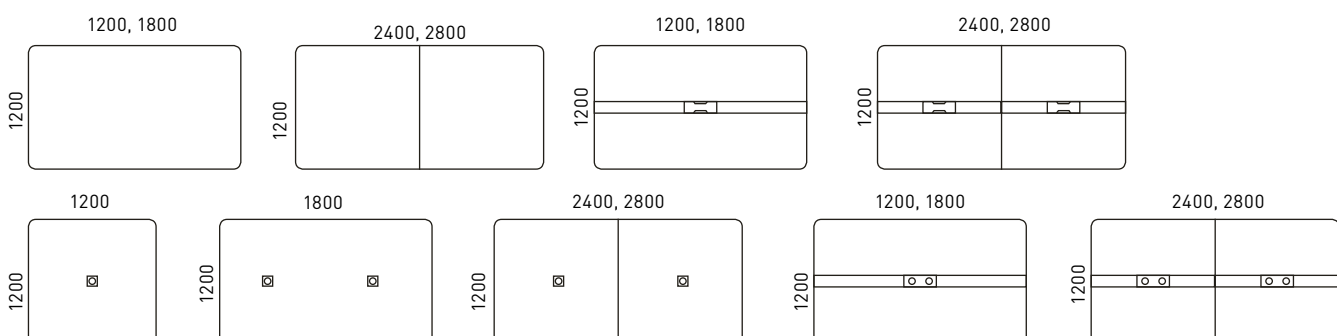

Meeting tables with HPL tabletop

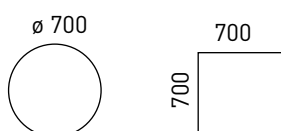

Coffee tables with melamine tabletop

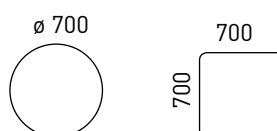

Coffee tables with HPL tabletop

ORDERING EXAMPLE

Code structure

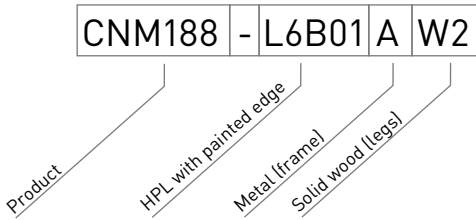
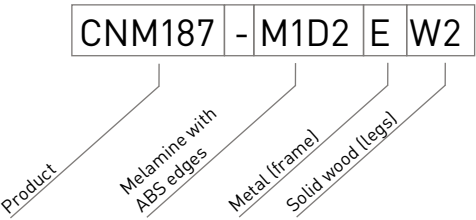

Optional



Power socket blocks



Cable clips



Cable ducts