

PENISOLA - PENINSULA **MADE IN ITALY**

SCHEDA DI MONTAGGIO/BOARD ASSEMBLY

COD.: B8IDCPE1IST.001.01

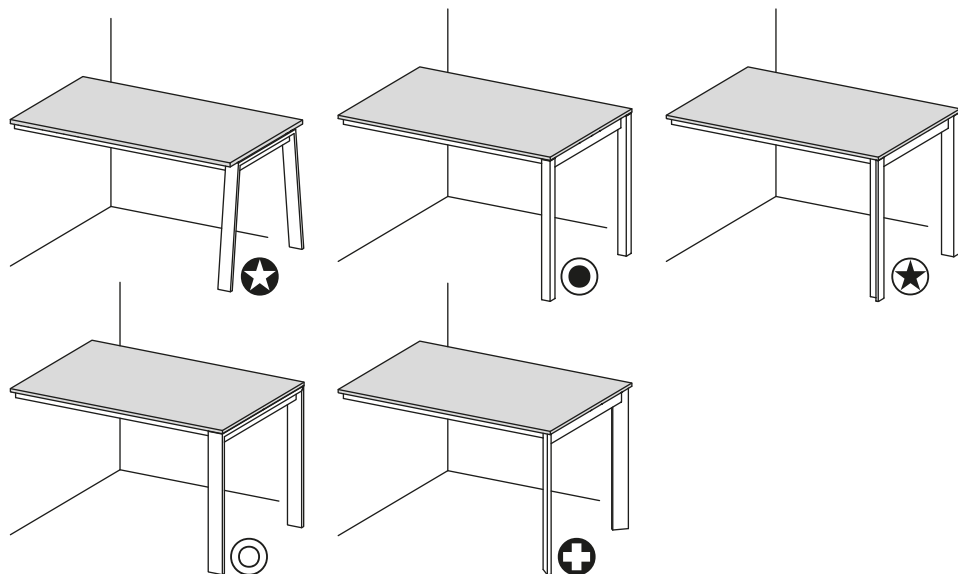

IT - Prima di iniziare il montaggio identificare tutti i componenti con l'aiuto delle istruzioni.

EN - Before starting to assembly, please identify all components.

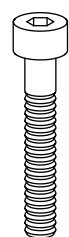
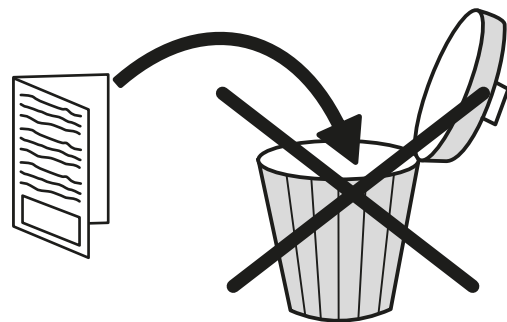

A x 8

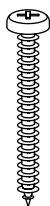

B x 4



C x 6



D x 6

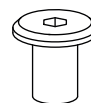

E x 6



F x 4

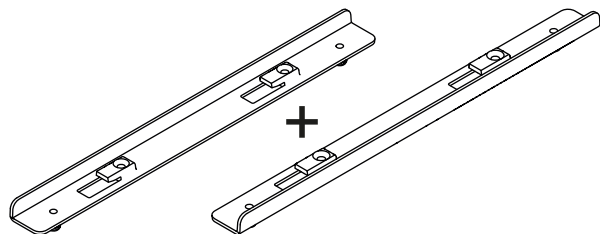

G x 1

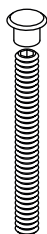

H x 4



I x 2



L x 2

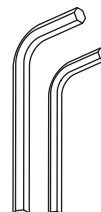

x 4

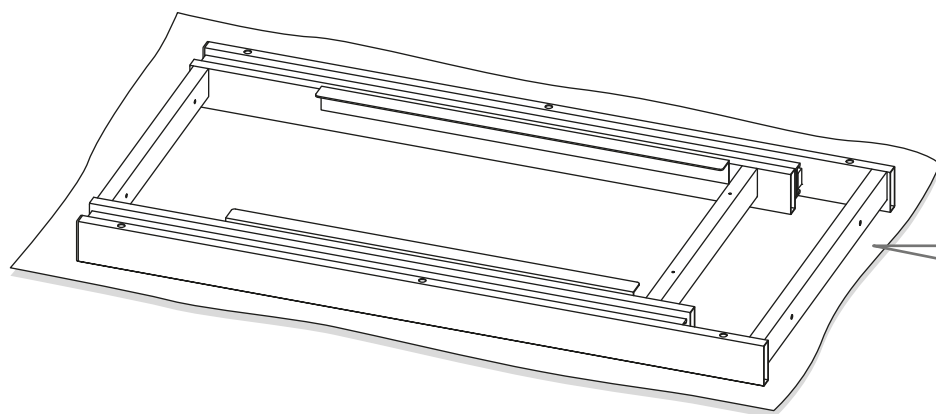
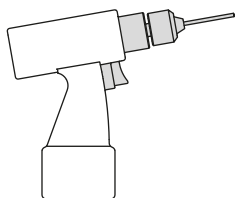
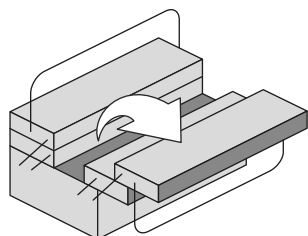

IT - PER IL MONTAGGIO POSIZIONARSI SU UNA SUPERFICIE MORBIDA O UTILIZZARE LA CONFEZIONE D'IMBALLO

EN - FOR THE MOUNTING POSITION ON A SOFT SURFACE OR USE THE BOX PACKING



1

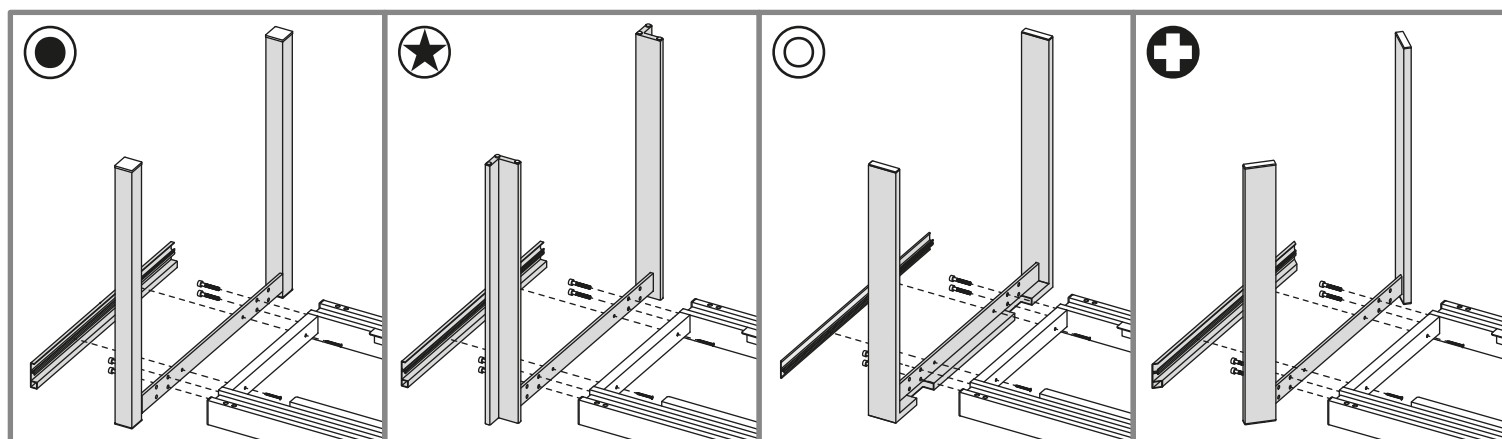
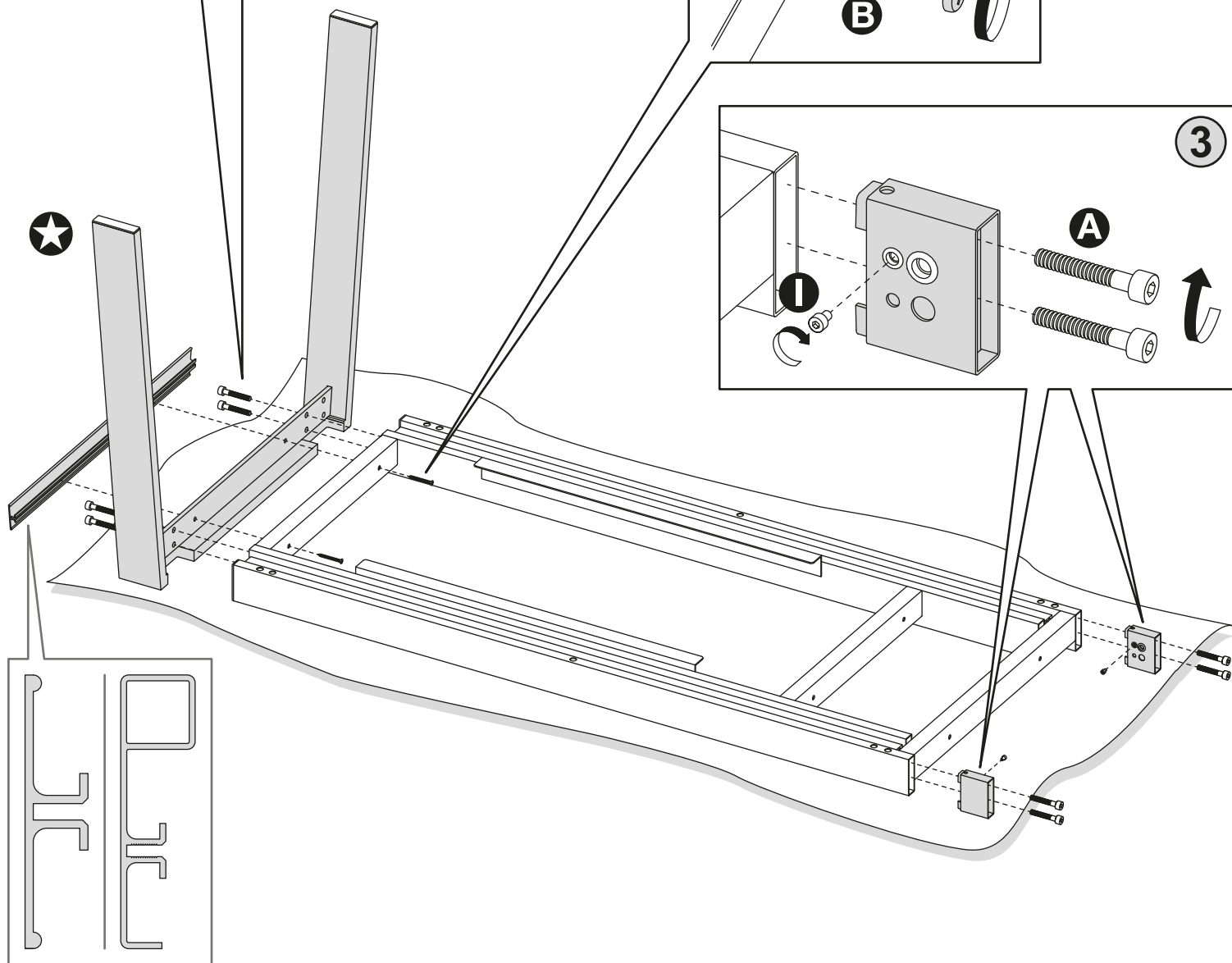
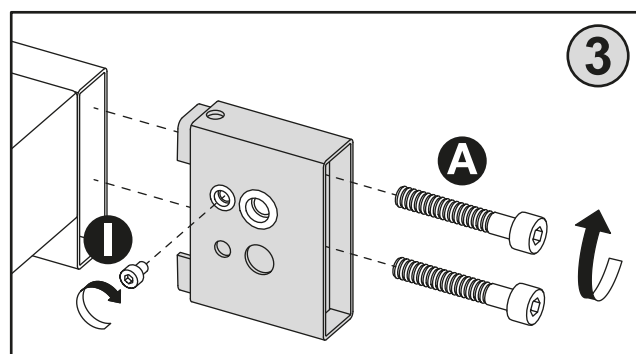
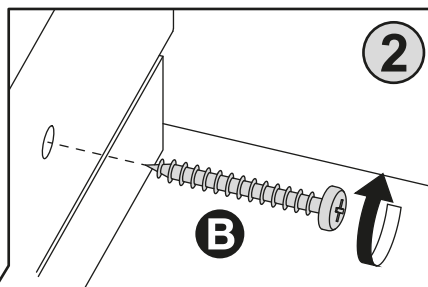
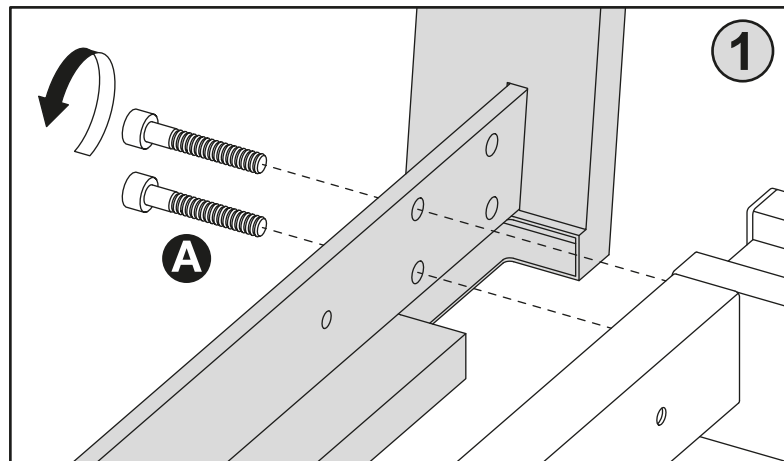

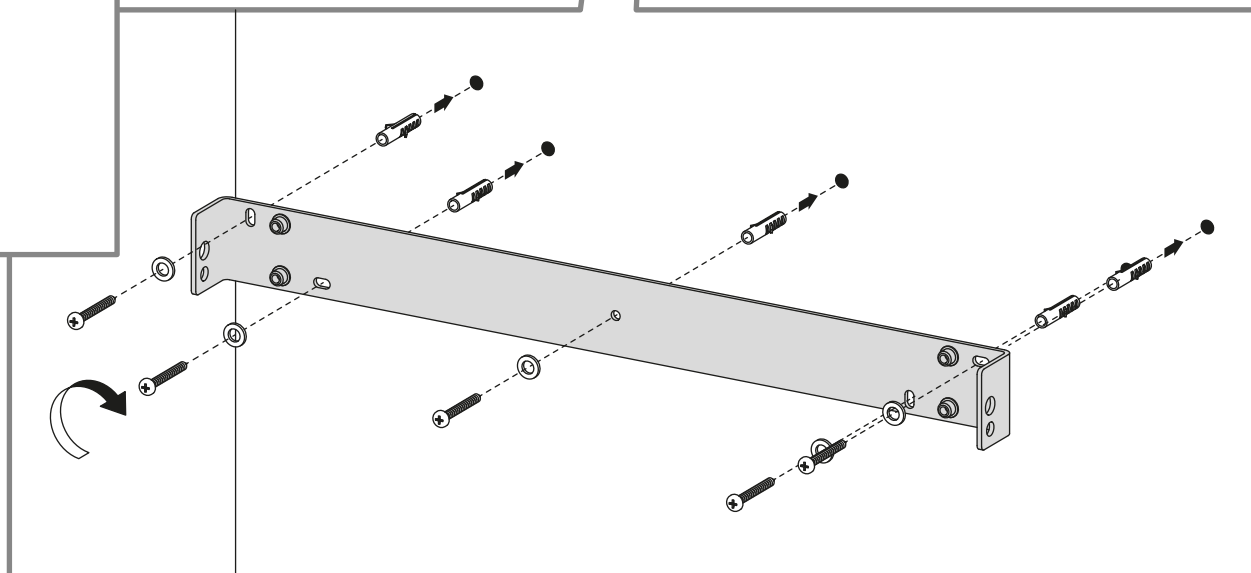
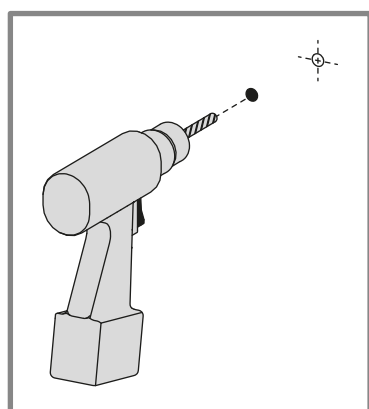
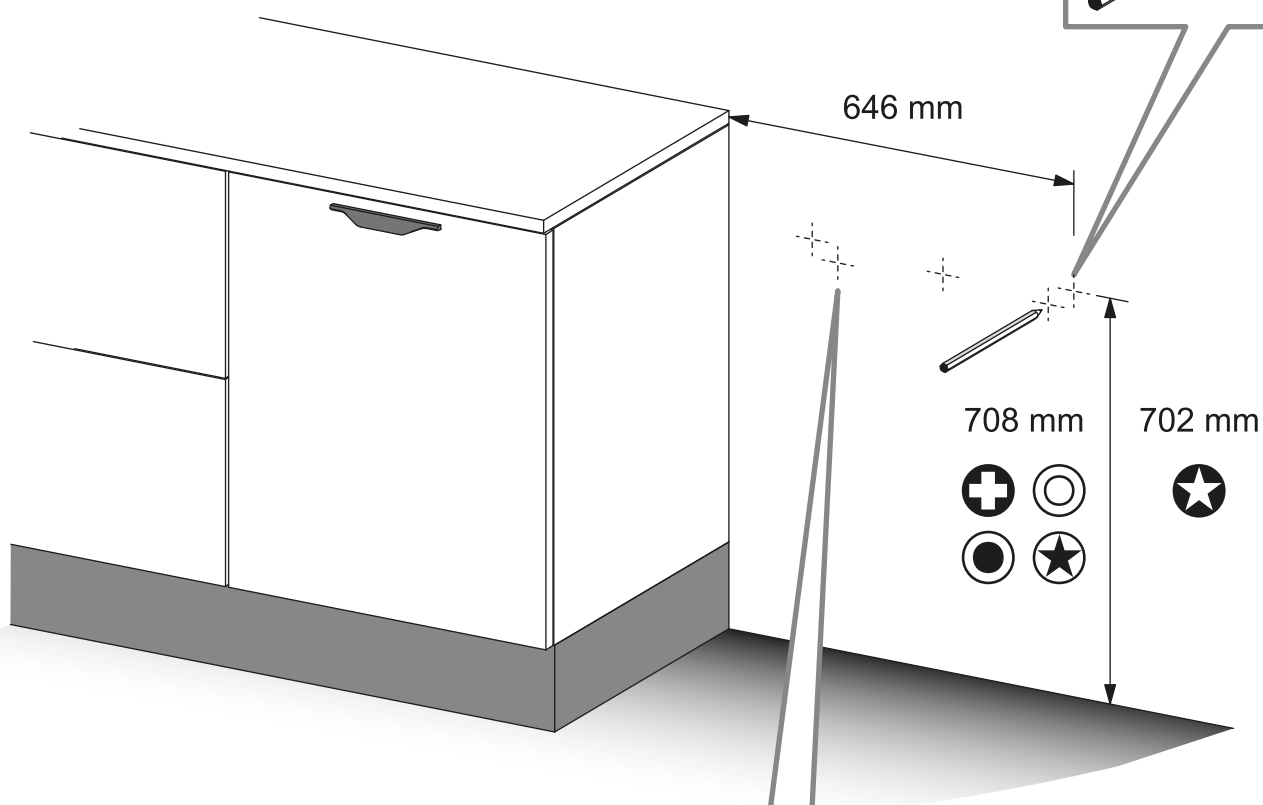
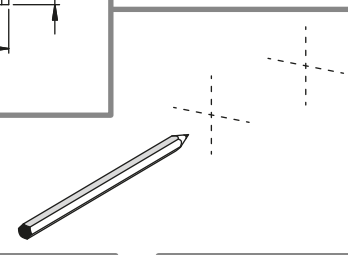
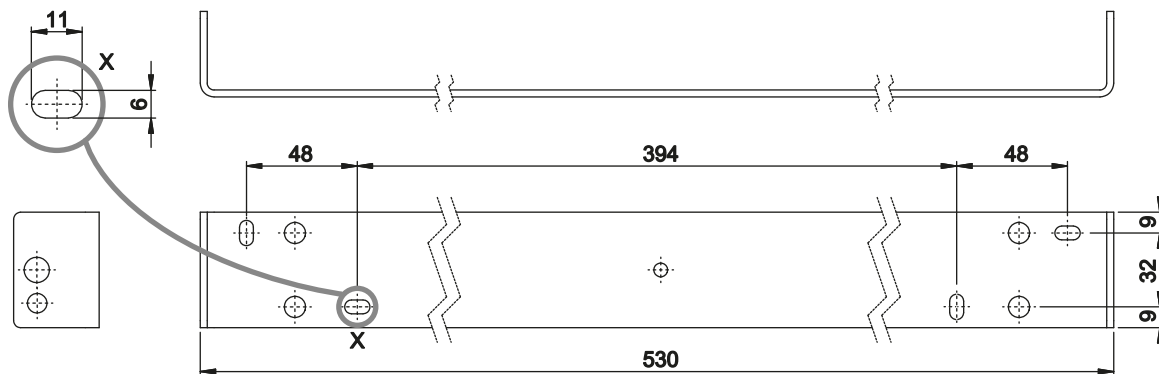

3

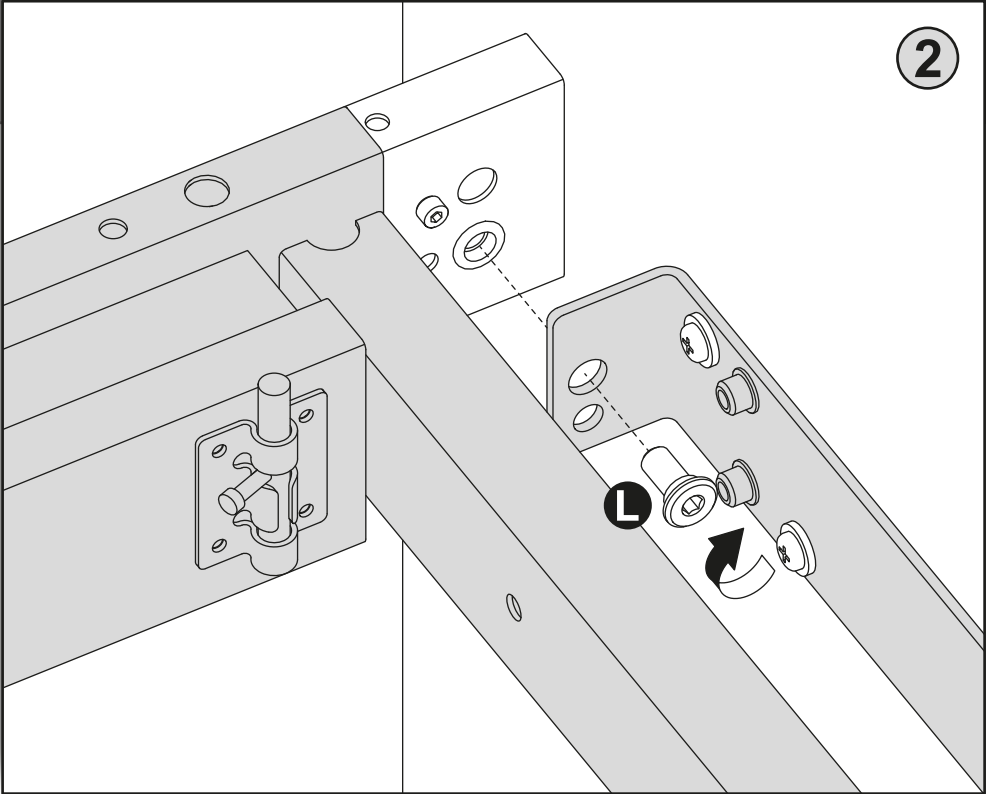
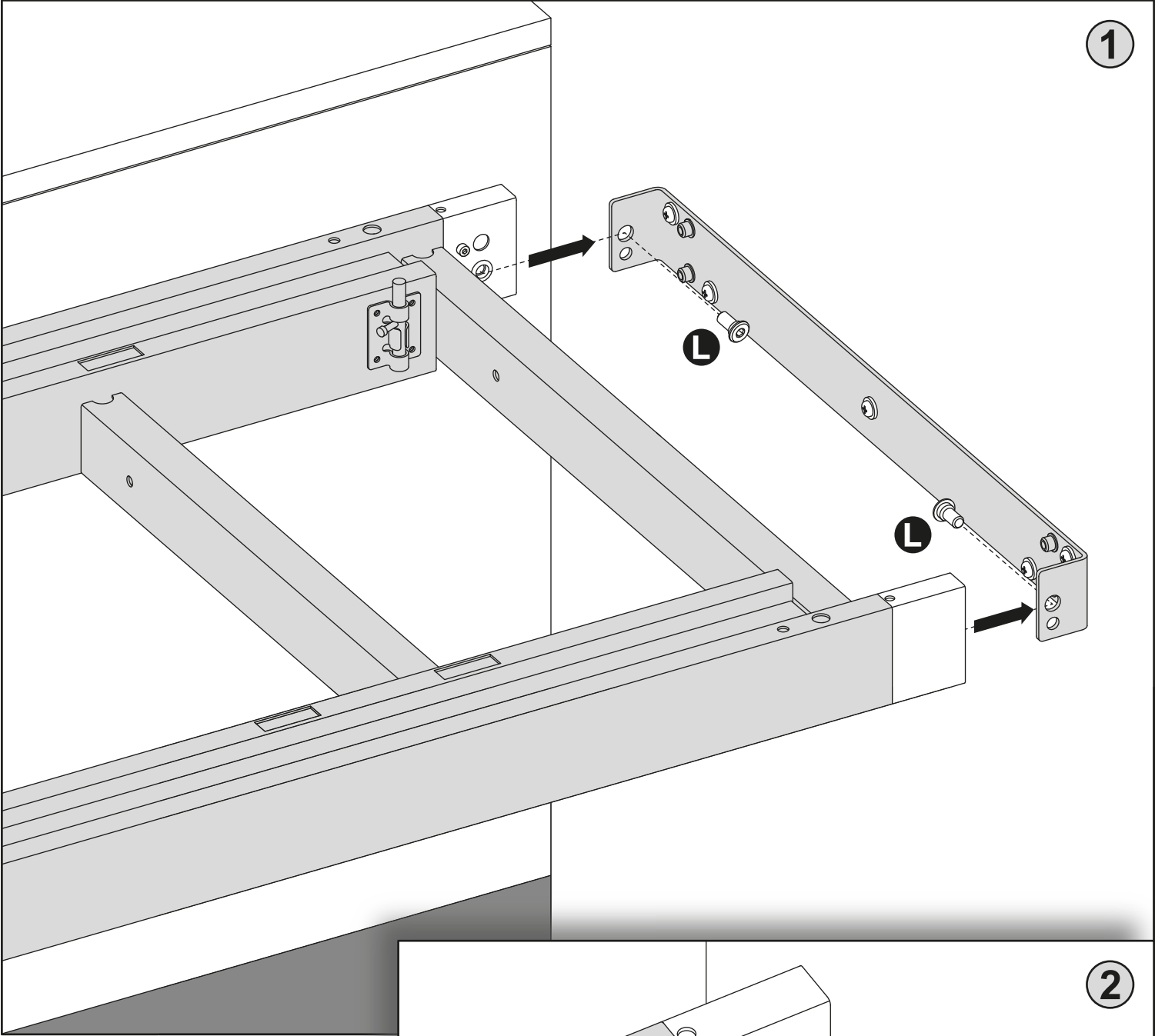

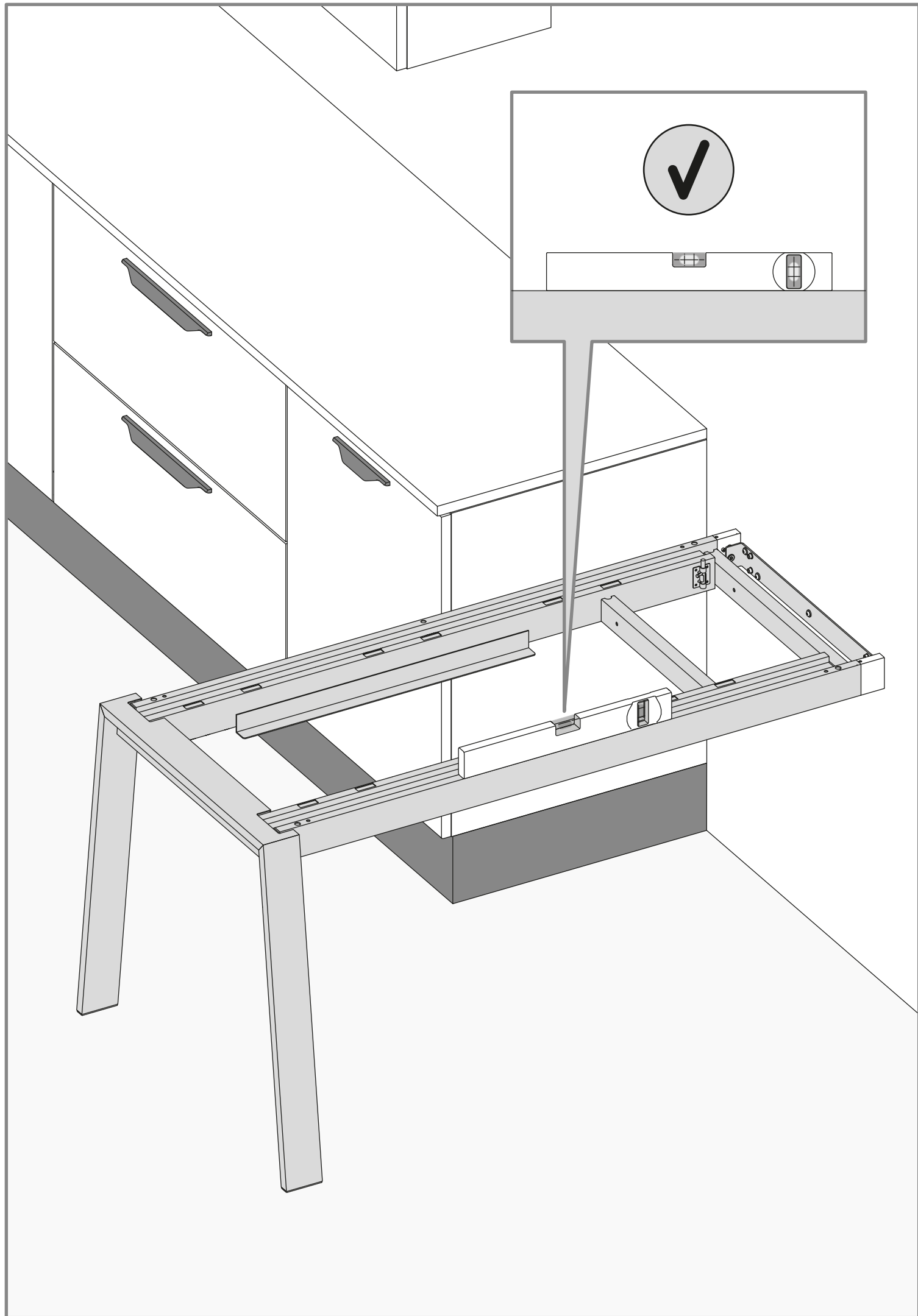

4

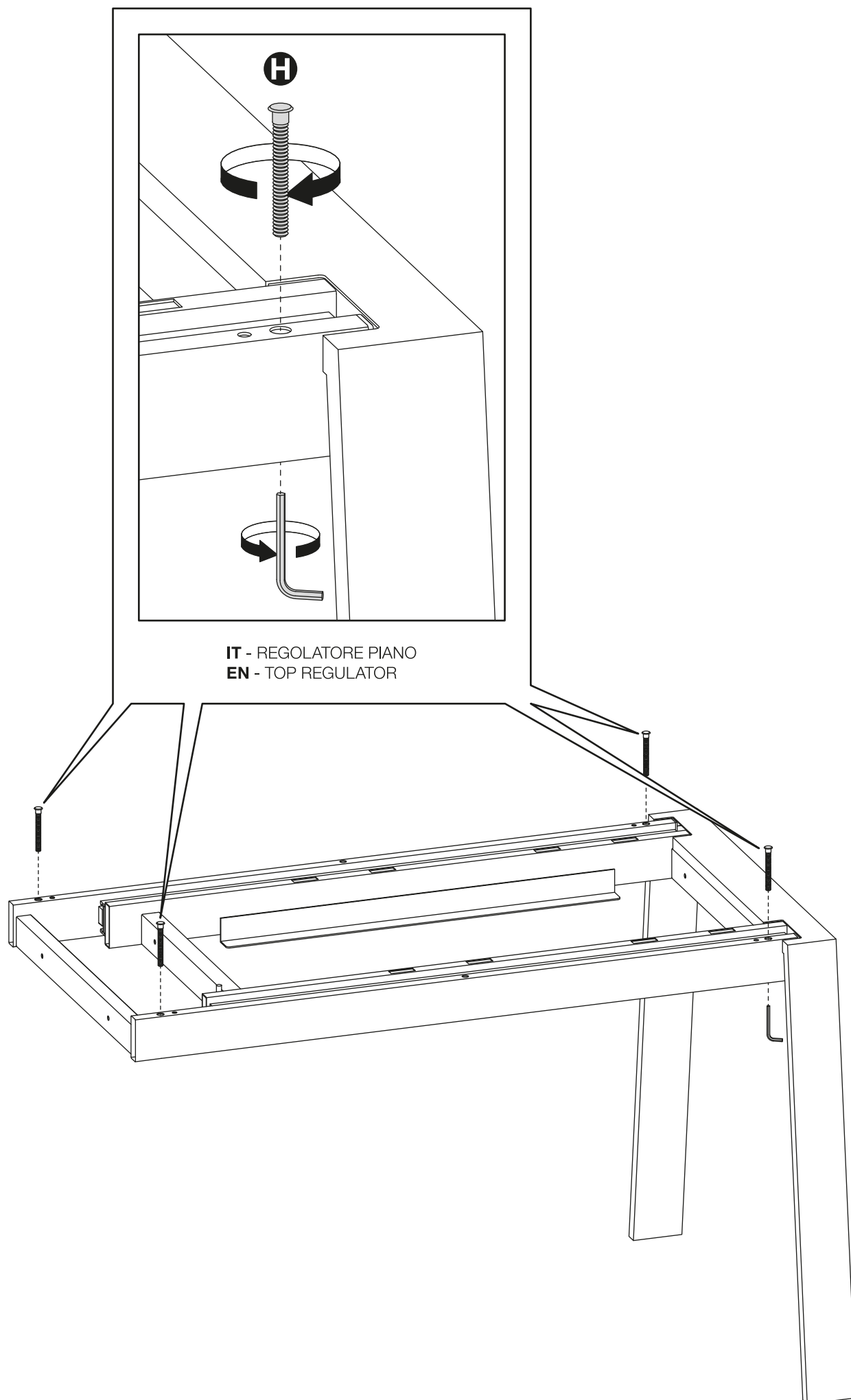

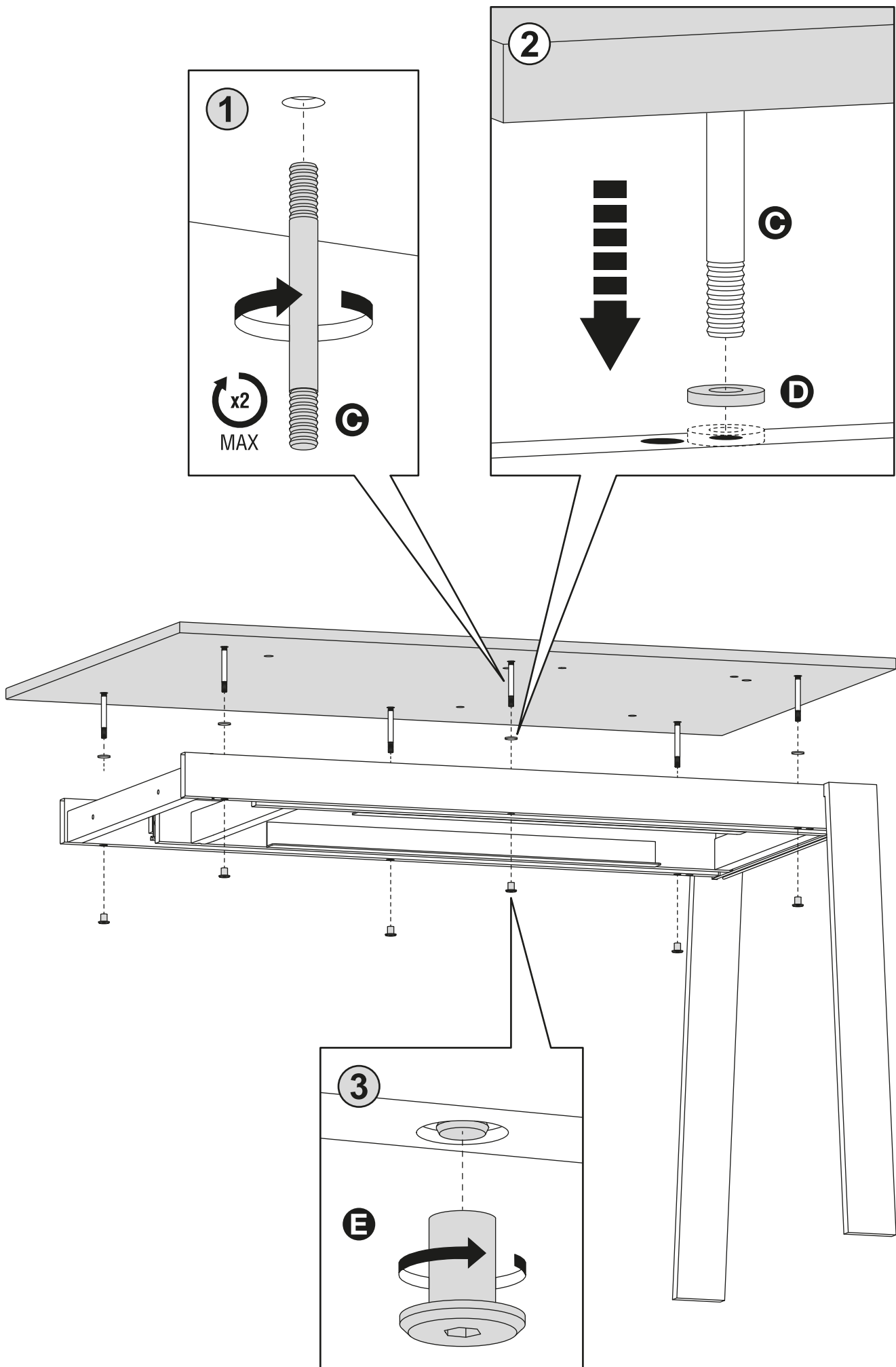

5B

TAVOLO CON RIVESTIMENTI - TABLE WITH COATINGS

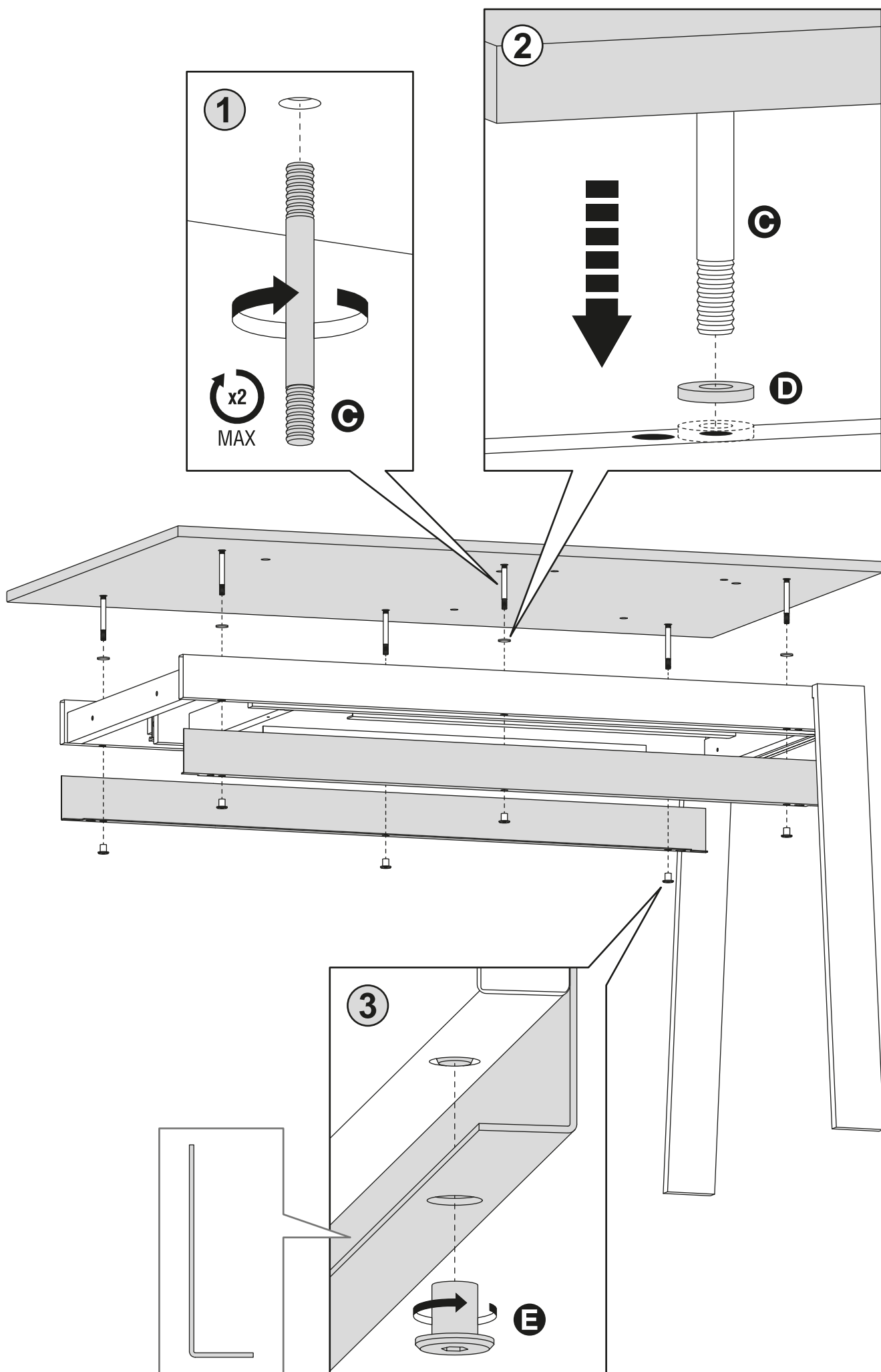

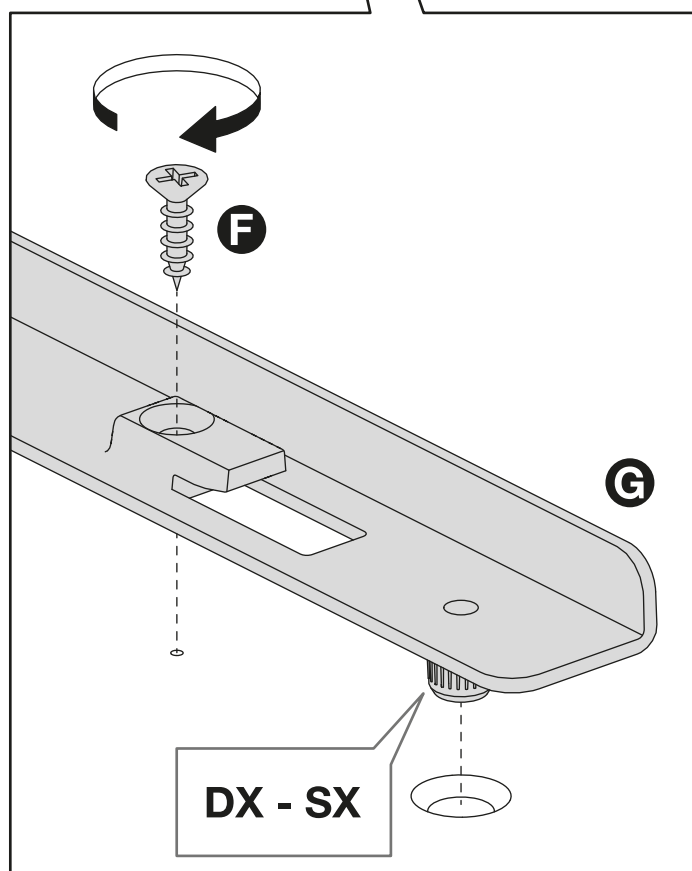
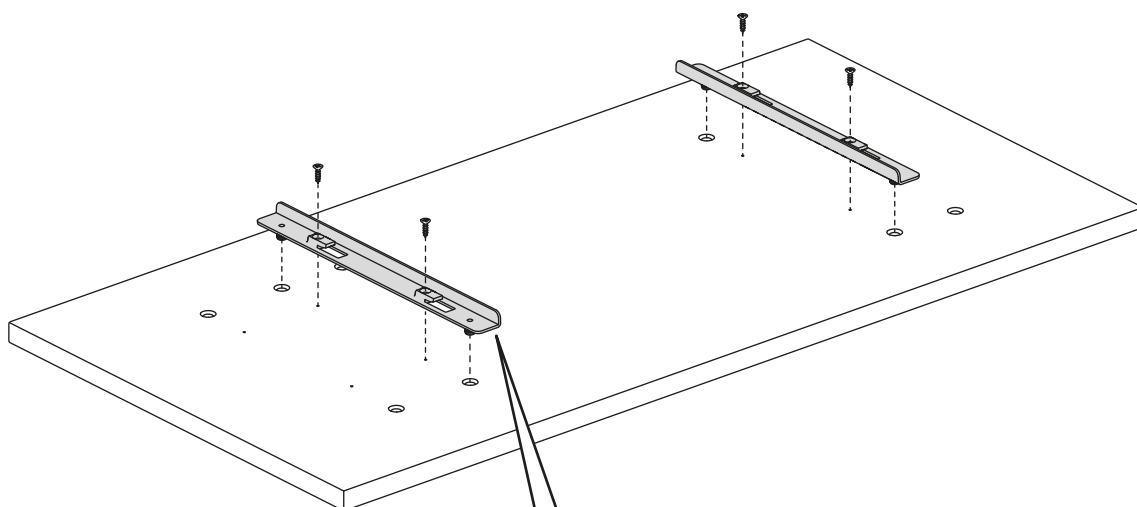

7

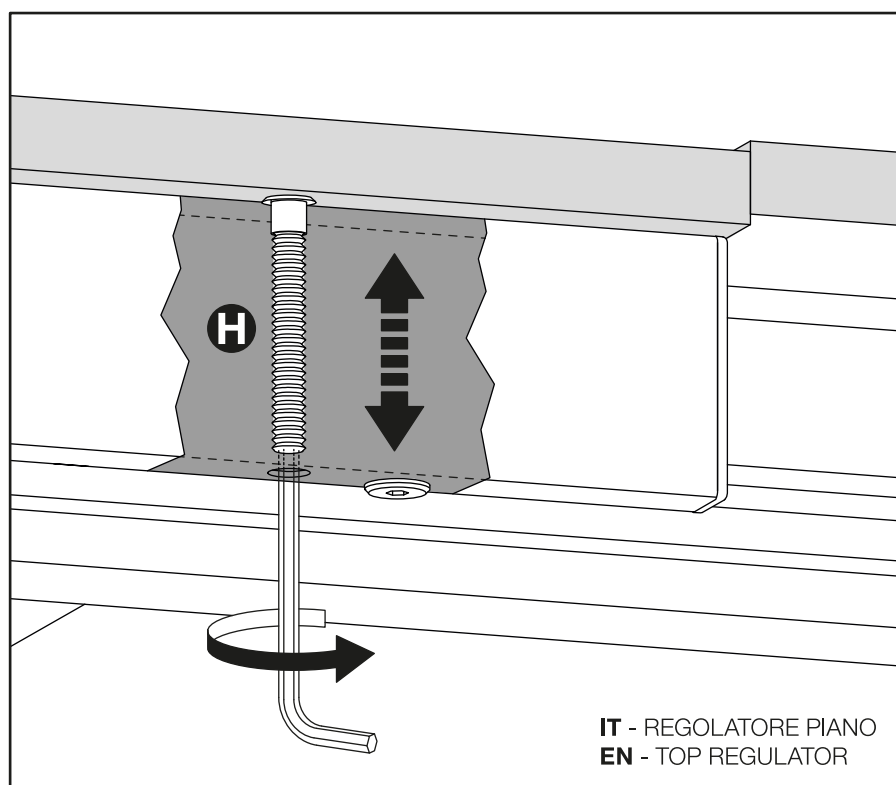
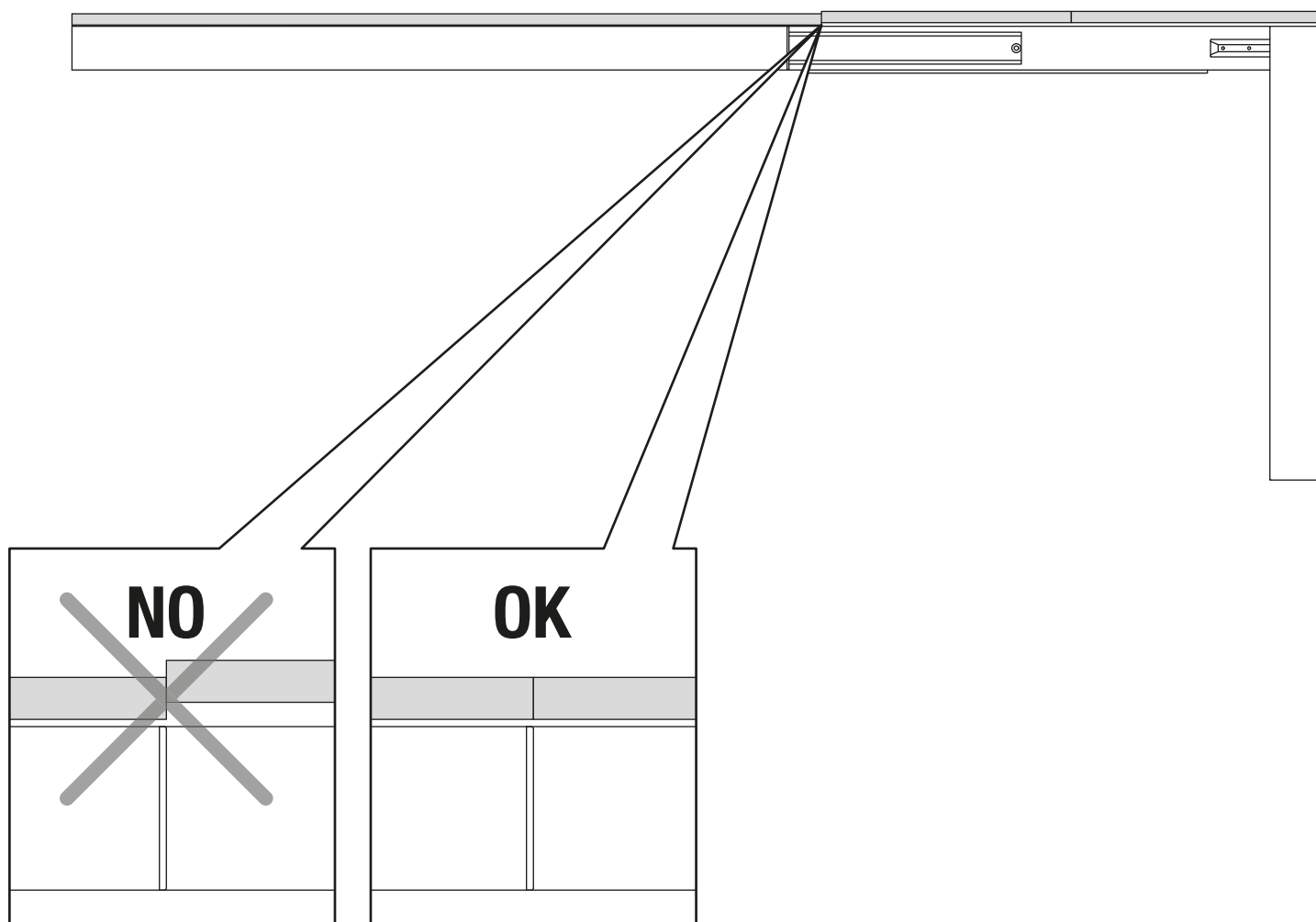

ALLUNGAMENTO PENISOLA - PENINSULA EXTENSION

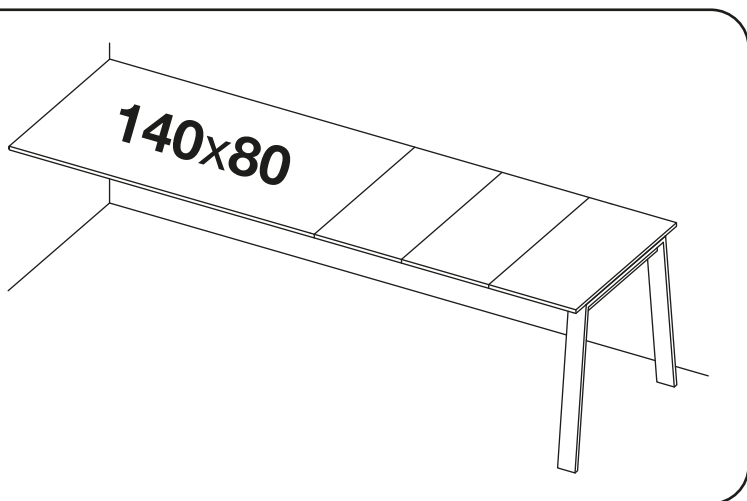
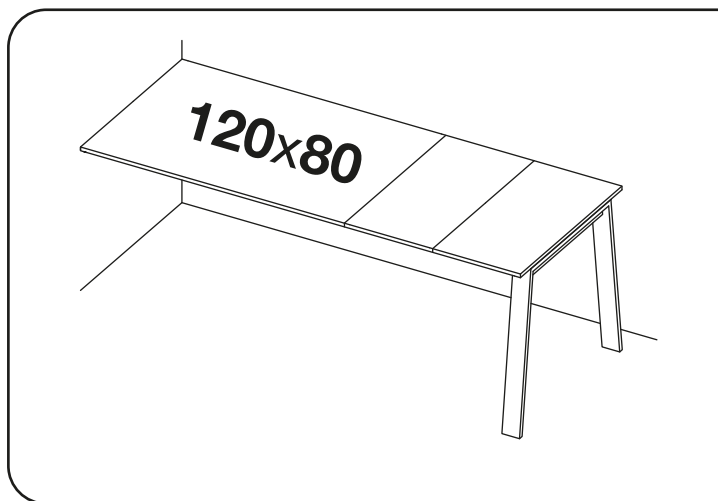
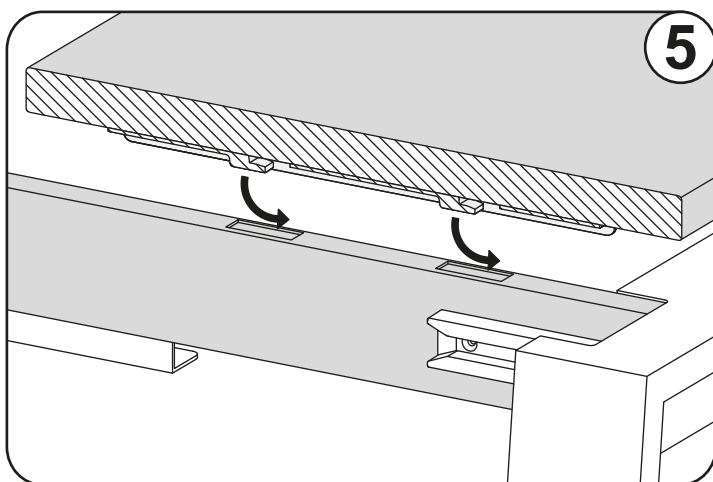
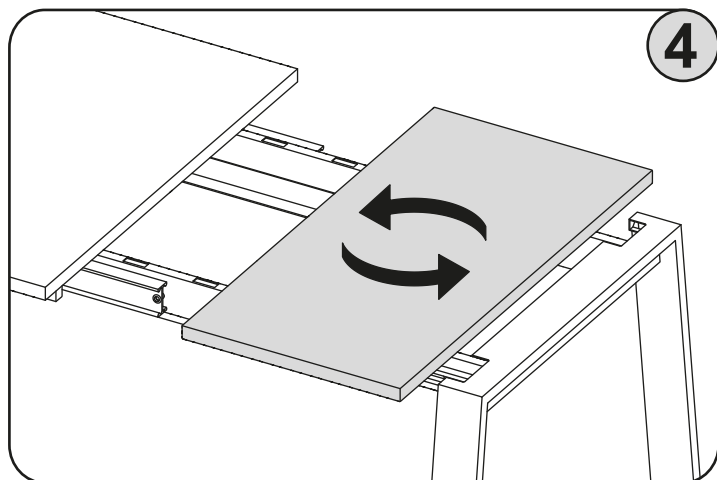
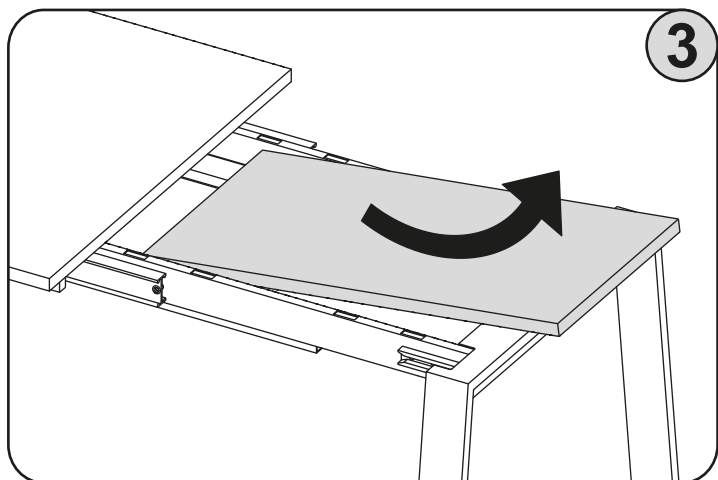
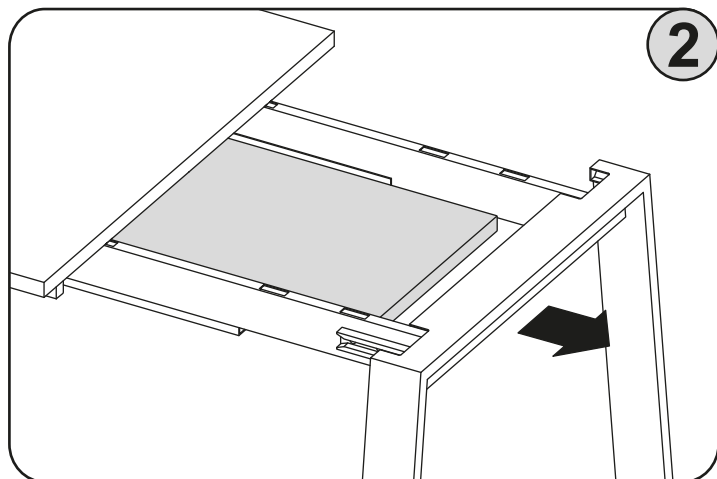
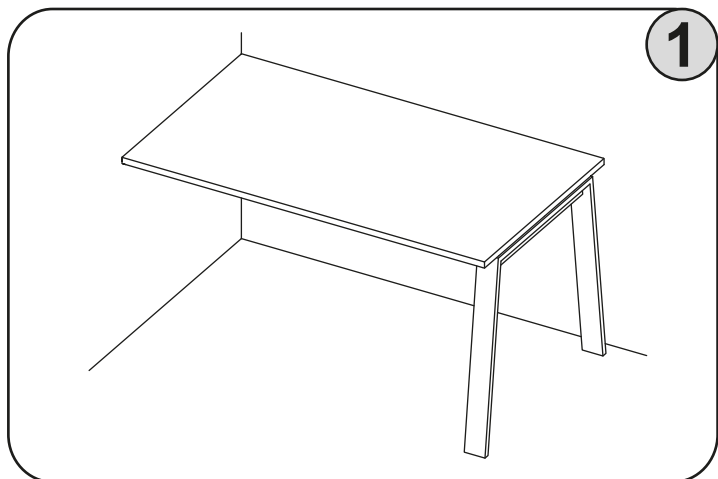

**COMUNICAZIONI AL CLIENTE LA PRESENTE SCHEDA PRODOTTO
DEVE ESSERE CONSEGNATA AL CLIENTE UNITAMENTE ALLA
MERCE ACQUISTATA**

Materiali:

- Struttura in metallo verniciato a polveri epossidiche
- Piani e allunghe nobilitato melamminico o laminato sp. 18 mm
- Piani in vetro "GLUE POINT" con vetro temperato di sicurezza sp. 6 mm

Istruzioni d'uso:

- Per il montaggio fare riferimento alle relative istruzioni
- Al fine di garantire la stabilità e la durata nel tempo dell'articolo, si consiglia di verificare periodicamente il corretto serraggio delle viterie
- Il prodotto non è adatto ad uso esterno
- Si consiglia di non salire sul tavolo
- In caso di spostamento del tavolo sollevarlo in modo adeguato
- In caso di estensione del piano fare attenzione a non infraporre le dita
- Il contatto delle superfici del prodotto con corpi caldi può danneggiare il materiale
- Per interventi di straordinaria manutenzione o di riparazione rivolgersi al rivenditore di fiducia
- Una volta dismessi il prodotto od i suoi componenti non vanno dispersi nell'ambiente, ma conferiti ai sistemi pubblici di smaltimento rifiuti

Consigli di manutenzione:

- I liquidi rovesciati devono essere assorbiti immediatamente con un panno pulito e asciutto
- Per la pulizia delle parti in metallo, utilizzare esclusivamente prodotti specifici
- Per la pulizia delle parti in legno, utilizzare esclusivamente prodotti specifici
- Per la pulizia delle parti in vetro, utilizzare esclusivamente prodotti specifici
- Non usare prodotti abrasivi

**LA POINT S.R.L. DECLINA OGNI RESPONSABILITÀ DERIVANTE DA UN
USO IMPROPRIO DELL'OGGETTO SOPRA DESCRITTO**

**CUSTOMER INFORMATION THIS PRODUCT LIST MUST BE DELIVERED
TO THE CUSTOMER TOGETHER WITH THE PURCHASED MATERIAL**

Materials:

- Steel structure epoxy varnished
- Laminated or melamine top and extensions 18 mm thick
- Glass top "GLUE POINT" with safety tempered glass 6 mm thick

User instructions:

- Refer to the instructions for assembly
- In order to guarantee stability and life of the article, periodically check that the screws are correctly tightened
- The product is not suitable for outdoor use
- It is recommended not to climb on the table
- When moving the table, make sure that it is lifted properly
- When extending the top, be careful not to trap fingers
- Contact with hot items can damage the surface
- For major maintenance or repairs, consult the retailer
- Once the product or its components are no longer used, make sure that they are disposed of correctly through the public waste disposal services

Maintenance recommendations:

- Any spills should be wiped up immediately with a clean, dry cloth
- To clean metal parts, use products that are specifically for metal
- To clean wooden parts, use products that are specifically for wood
- To clean glass parts, use products that are specifically for glass
- Do not use abrasive products

**POINT S.R.L. DISCLAIMS ANY RESPONSIBILITY DERIVING FROM
INCORRECT USE OF THE ABOVE MENTIONED OBJECT**